

Soils Map

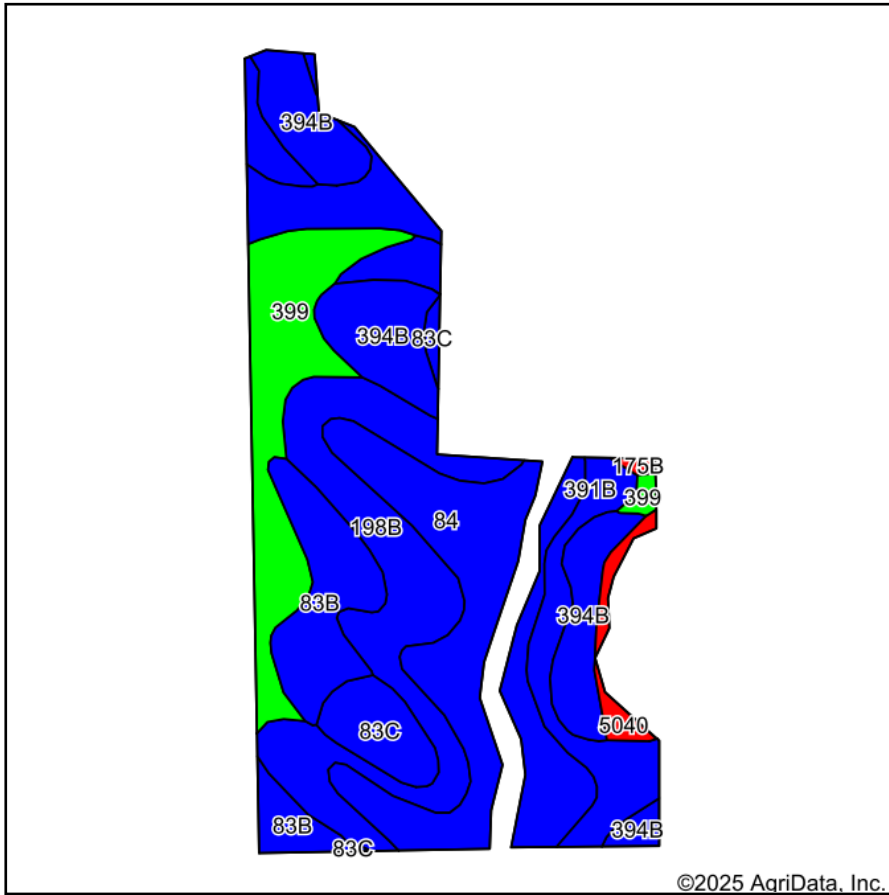

©2025 AgriData, Inc.

Soils data provided by USDA and NRCS.

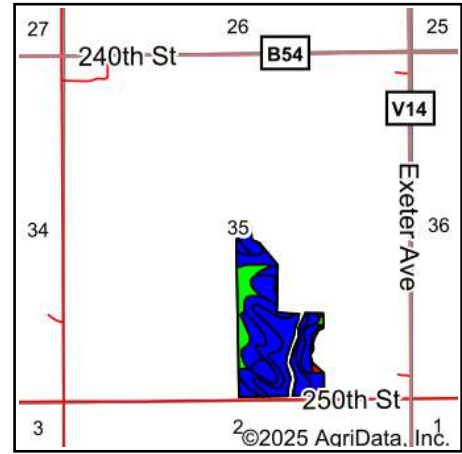

State: **Iowa**
 County: **Chickasaw**
 Location: **35-95N-14W**
 Township: **Chickasaw**
 Acres: **49.56**
 Date: **10/23/2025**



Maps Provided By:



© AgriData, Inc. 2023

www.AgriDataInc.com



Area Symbol: IA037, Soil Area Version: 31

Code	Soil Description	Acres	Percent of field	CSR2 Legend	Non-Irr Class *c	*i Corn Bu	*i Soybeans Bu	CSR2**	CSR	Bromegrass alfalfa AUM	Bromegrass alfalfa hay Tons	Corn Bu	Kentucky bluegrass AUM	Oats Bu	Smooth bromegrass AUM	S...
84	Clyde clay loam, 0 to 3 percent slopes	13.32	26.7%		llw	224.0	65.0	88	74							
198B	Floyd loam, 1 to 4 percent slopes	10.15	20.5%		llw	222.4	64.5	89	74							
394B	Ostrander loam, 2 to 5 percent slopes	7.36	14.9%		lle	225.6	65.4	88	84							
399	Readlyn silt loam, 1 to 3 percent slopes	6.48	13.1%		lw	220.8	64.0	91	89							
83B	Kenyon loam, 2 to 5 percent slopes	5.58	11.3%		lle	225.6	65.4	90	84							
391B	Clyde-Floyd complex, 1 to 4 percent slopes	3.52	7.1%		llw	216.0	62.6	87	72							
83C	Kenyon loam, 5 to 9 percent slopes	2.23	4.5%		llle	209.6	60.8	85	69	10.6	6.4	188	3.7	90.5	6.2	

Soils data provided by USDA and NRCS.



Code	Soil Description	Acres	Percent of field	CSR2 Legend	Non-Irr Class *c	*i Corn Bu	*i Soybeans Bu	CSR2**	CSR	Bromegrass alfalfa AUM	Bromegrass alfalfa hay Tons	Corn Bu	Kentucky bluegrass AUM	Oats Bu	Smooth bromegrass AUM	S B
5040	Anthropotic Udorthents, 2 to 9 percent slopes	0.79	1.6%		Vls	88.0	25.5	5								
175B	Dickinson fine sandy loam, 2 to 5 percent slopes	0.13	0.3%		Ille	80.0	23.2	50	54							
Weighted Average						1.98	219.9	63.8	87.2	*-	0.5	0.3	8.5	0.2	4.1	0.3

**IA has updated the CSR values for each county to CSR2.

*- CSR weighted average cannot be calculated on the current soils data, use prior data version for csr values.*i Yield data provided by the ISPAID Database version 8.1.1 developed by IA State University.

*n: The aggregation method is "Weighted Average using all components"

*c: Using Capabilities Class Dominant Condition Aggregation Method