

# Soils Map

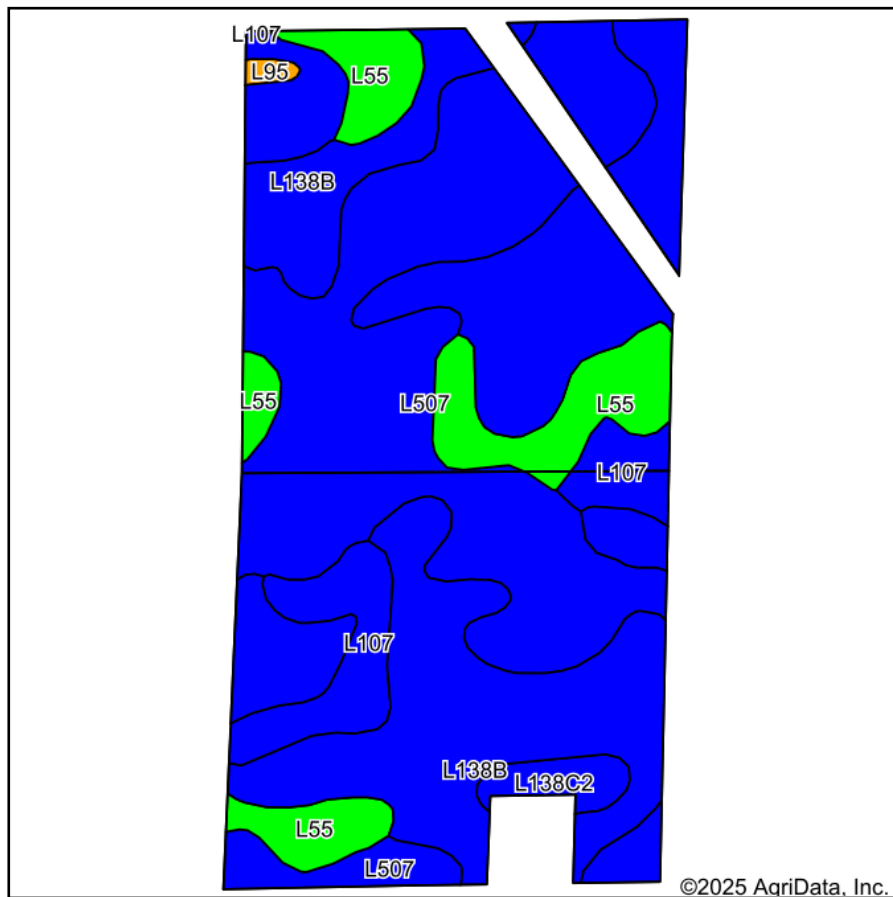

Soils data provided by USDA and NRCS.

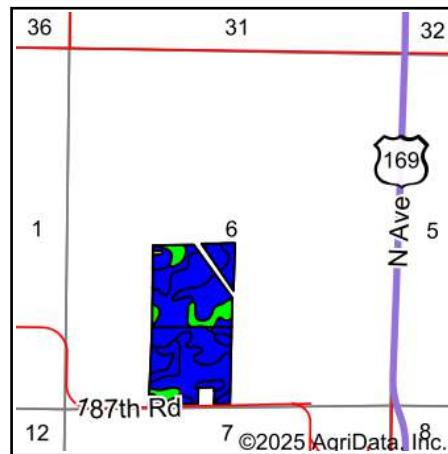

State: **Iowa**  
 County: **Dallas**  
 Location: **6-80N-27W**  
 Township: **Sugar Grove**  
 Acres: **74.78**  
 Date: **4/10/2025**



Maps Provided By:  
  
 CUSTOMIZED ONLINE MAPPING  
 © AgriData, Inc. 2023 www.AgriDataInc.com



Area Symbol: IA049, Soil Area Version: 31

| Code             | Soil Description                                                       | Acres | Percent of field | CSR2 Legend | Non-Irr Class *c | CSR2** | *n NCCPI Overall | *n NCCPI Corn | *n NCCPI Small Grains | *n NCCPI Soybeans |
|------------------|------------------------------------------------------------------------|-------|------------------|-------------|------------------|--------|------------------|---------------|-----------------------|-------------------|
| L138B            | Clarion loam, Bemis moraine, 2 to 6 percent slopes                     | 30.56 | 40.9%            |             | Ile              | 88     | 79               | 75            | 70                    | 79                |
| L507             | Canisteo clay loam, Bemis moraine, 0 to 2 percent slopes               | 29.23 | 39.1%            |             | Ilw              | 87     | 81               | 70            | 68                    | 81                |
| L55              | Nicollet loam, 1 to 3 percent slopes                                   | 8.23  | 11.0%            |             | Ie               | 91     | 84               | 77            | 74                    | 84                |
| L107             | Webster clay loam, Bemis moraine, 0 to 2 percent slopes                | 5.25  | 7.0%             |             | Ilw              | 88     | 84               | 77            | 72                    | 83                |
| L138C2           | Clarion loam, Bemis moraine, 6 to 10 percent slopes, moderately eroded | 1.26  | 1.7%             |             | IIle             | 83     | 64               | 63            | 59                    | 64                |
| L95              | Harps clay loam, Bemis moraine, 0 to 2 percent slopes                  | 0.25  | 0.3%             |             | Ilw              | 75     | 80               | 68            | 69                    | 80                |
| Weighted Average |                                                                        |       |                  |             | 1.91             | 87.8   | *n 80.4          | *n 73.2       | *n 69.6               | *n 80.4           |

\*\*IA has updated the CSR values for each county to CSR2.

\*n: The aggregation method is "Weighted Average using all components"

\*c: Using Capabilities Class Dominant Condition Aggregation Method