

Soils Map

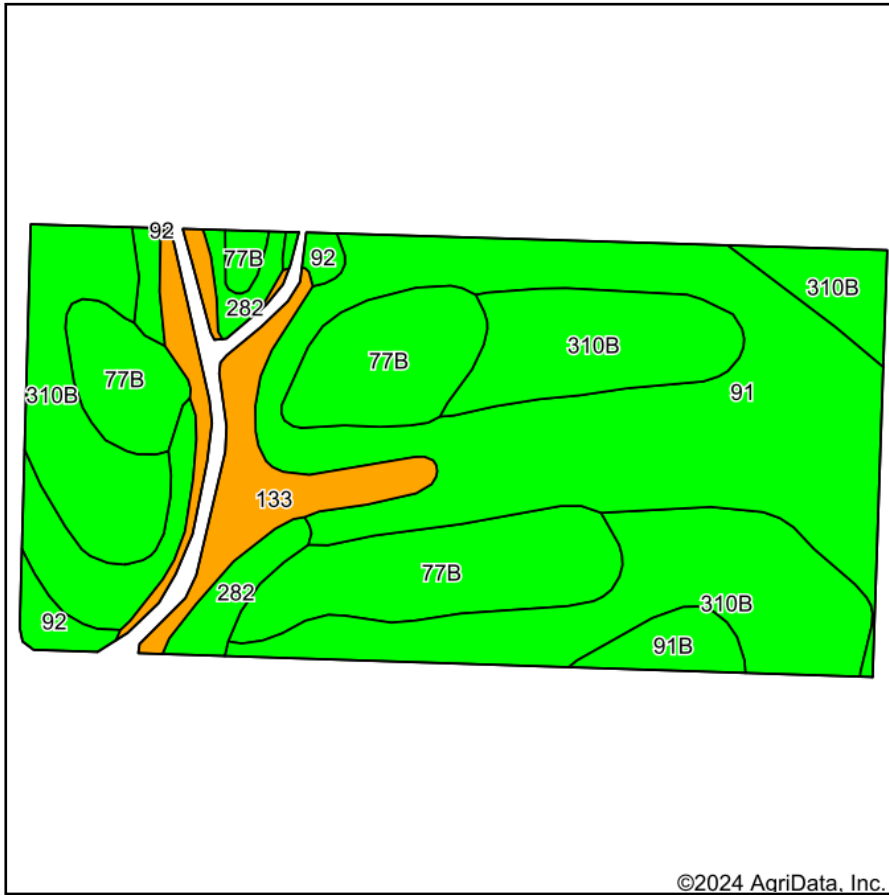

©2024 AgriData, Inc.

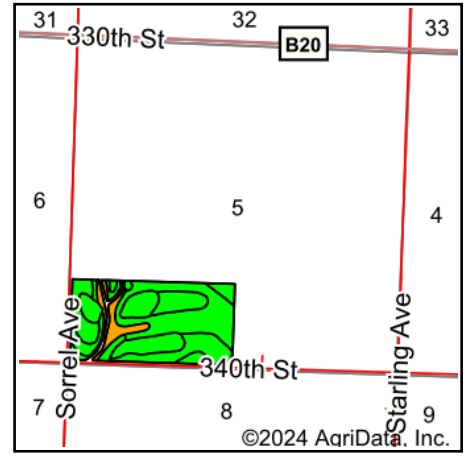

©2024 AgriData, Inc.

State: **Iowa**
 County: **O'Brien**
 Location: **5-96N-40W**
 Township: **Center**
 Acres: **74.45**
 Date: **7/24/2024**



Maps Provided By:



© AgriData, Inc. 2023

www.AgriDataInc.com



Soils data provided by USDA and NRCS.

Area Symbol: IA141, Soil Area Version: 28

Code	Soil Description	Acres	Percent of field	CSR2 Legend	Non-Irr Class *c	CSR2**	CSR	*n NCCPI Overall	*n NCCPI Corn	*n NCCPI Small Grains	*n NCCPI Soybeans	
91	Primghar silty clay loam, 0 to 2 percent slopes	25.97	34.8%		lw	100	80	78	74	73	78	
310B	Galva silty clay loam, 2 to 5 percent slopes	23.23	31.2%		lle	95	70	75	74	71	75	
77B	Sac silty clay loam, loam substratum, 2 to 5 percent slopes	14.28	19.2%		lle	95	68	77	73	70	77	
133	Colo silty clay loam, deep loess, 0 to 2 percent slopes, occasionally flooded	5.91	7.9%		llw	78	73	81	75	36	80	
282	Ransom silty clay loam, 1 to 3 percent slopes	2.21	3.0%		lw	100	75	81	79	70	81	
91B	Primghar silty clay loam, 2 to 5 percent slopes	1.53	2.1%		lle	95	78	78	74	73	78	
92	Marcus silty clay loam, 0 to 2 percent slopes	1.32	1.8%		llw	94	75	75	74	68	75	
Weighted Average						1.62	95.5	73.7	*n 77.1	*n 74	*n 68.7	*n 77.1

**IA has updated the CSR values for each county to CSR2.

*n: The aggregation method is "Weighted Average using all components"

*c: Using Capabilities Class Dominant Condition Aggregation Method

Soils data provided by USDA and NRCS.