

Soils Map

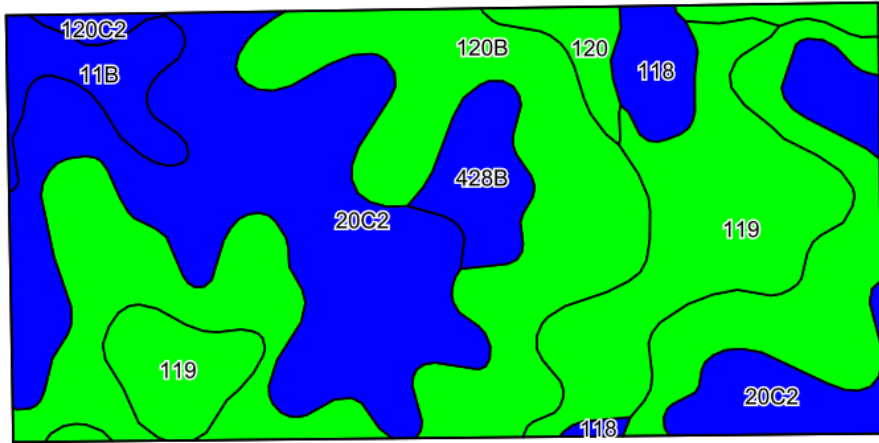

©2024 AgriData, Inc.

Soils data provided by USDA and NRCS.

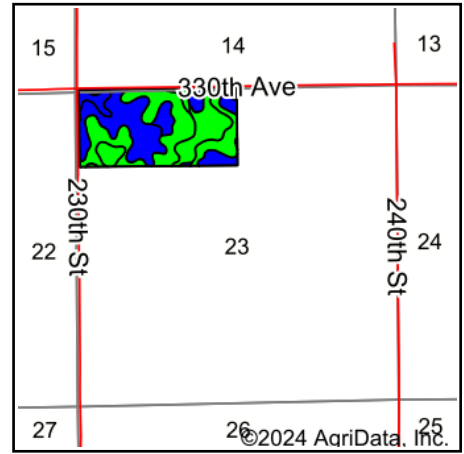

State: **Iowa**
 County: **Poweshiek**
 Location: **23-81N-13W**
 Township: **Jefferson**
 Acres: **80**
 Date: **6/13/2024**



Maps Provided By:
surety
 CUSTOMIZED ONLINE MAPPING
 © AgriData, Inc. 2023 www.AgriDataInc.com



Area Symbol: IA157, Soil Area Version: 27

Code	Soil Description	Acres	Percent of field	CSR2 Legend	Non-Irr Class *c	*i Corn Bu	*i Soybeans Bu	CSR2**	CSR	*n NCCPI Soybeans	
120B	Tama silty clay loam, 2 to 5 percent slopes	30.94	38.8%		Ile	232.0	67.3	95	93	79	
20C2	Killduff silty clay loam, 5 to 9 percent slopes, eroded	24.18	30.2%		IIle	206.4	59.9	81	73	79	
119	Muscatine silty clay loam, 0 to 2 percent slopes	13.78	17.2%		Iw	240.0	69.6	100	98	90	
11B	Colo-Ely complex, 0 to 5 percent slopes	3.08	3.8%		IIw	204.8	59.4	86	68	76	
428B	Ely silty clay loam, 2 to 5 percent slopes	2.93	3.7%		Ile	220.8	64.0	88	88	82	
120	Tama silty clay loam, 0 to 2 percent slopes	2.35	2.9%		I	240.0	69.6	100	98	78	
118	Garwin silty clay loam, 0 to 2 percent slopes	2.23	2.8%		IIw	230.4	66.8	90	93	72	
120C2	Tama silty clay loam, 5 to 9 percent slopes, eroded	0.51	0.6%		IIle	211.2	61.2	87	76	69	
Weighted Average						2.11	224.2	65	91	86.7	*n 80.6

**IA has updated the CSR values for each county to CSR2.

*i Yield data provided by the ISPAID Database version 8.1.1 developed by IA State University.

*n: The aggregation method is "Weighted Average using all components"

*c: Using Capabilities Class Dominant Condition Aggregation Method

Soils data provided by USDA and NRCS.