

Soils Map

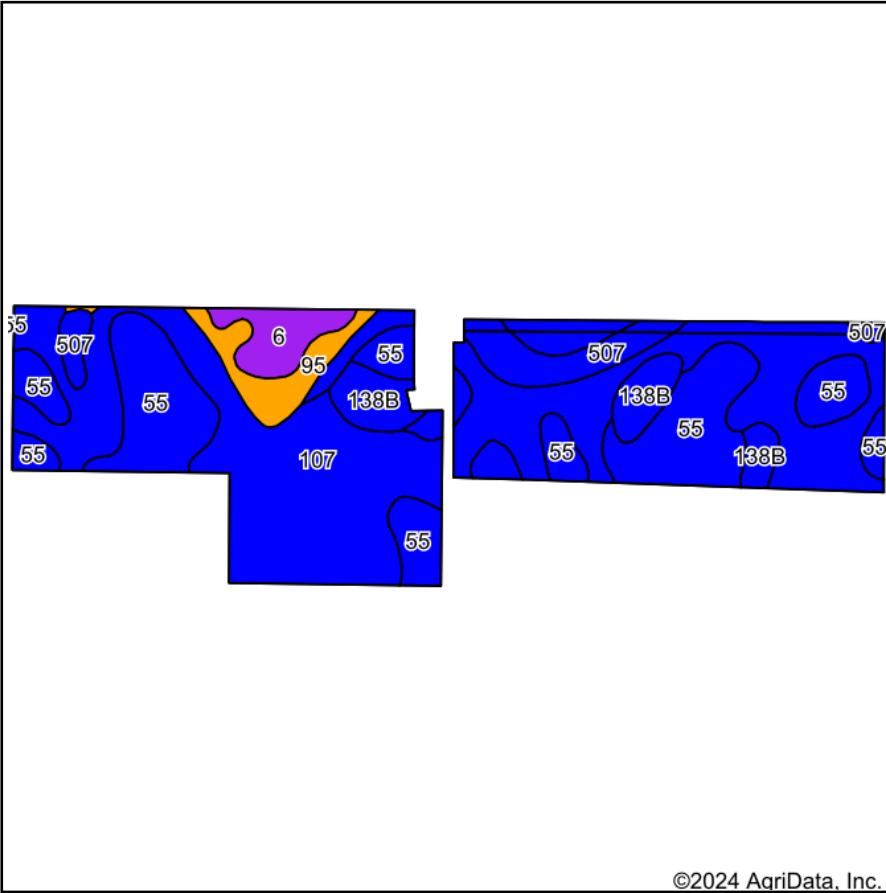

Soils data provided by USDA and NRCS.

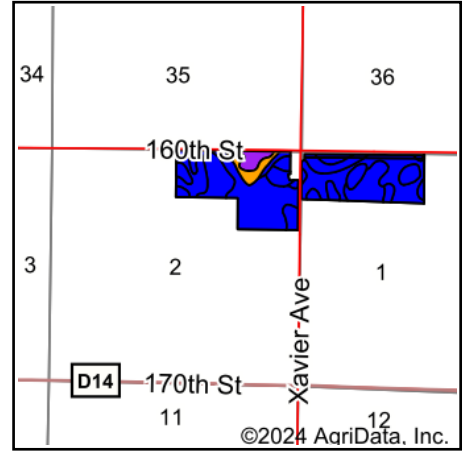

State: **Iowa**
 County: **Webster**
 Location: **2-89N-27W**
 Township: **Colfax**
 Acres: **135.37**
 Date: **3/5/2024**



Maps Provided By:

 © AgriData, Inc. 2023 www.AgriDataInc.com



Area Symbol: IA187, Soil Area Version: 40

Code	Soil Description	Acres	Percent of field	CSR2 Legend	Non-Irr Class *c	CSR2**	CSR	*n NCCPI Overall	*n NCCPI Corn	*n NCCPI Small Grains	*n NCCPI Soybeans	
107	Webster clay loam, 0 to 2 percent slopes	68.48	50.6%		llw	86	82	83	78	70	82	
55	Nicollet clay loam, 1 to 3 percent slopes	38.44	28.4%		lw	89	90	81	81	74	81	
507	Canisteo clay loam, 0 to 2 percent slopes	9.75	7.2%		llw	84	77	81	71	65	81	
138B	Clarion loam, 2 to 6 percent slopes	8.37	6.2%		lle	89	82	83	78	72	83	
95	Harps clay loam, 0 to 2 percent slopes	5.50	4.1%		llw	72	67	82	70	63	82	
6	Okoboji silty clay loam, 0 to 1 percent slopes	4.83	3.6%		lllw	59	62	77	74	74	74	
Weighted Average						1.75	85.4	82.6	*n 82	*n 77.9	*n 70.8	*n 81.4

**IA has updated the CSR values for each county to CSR2.

*n: The aggregation method is "Weighted Average using all components"

*c: Using Capabilities Class Dominant Condition Aggregation Method

Soils data provided by USDA and NRCS.