

# Soils Map

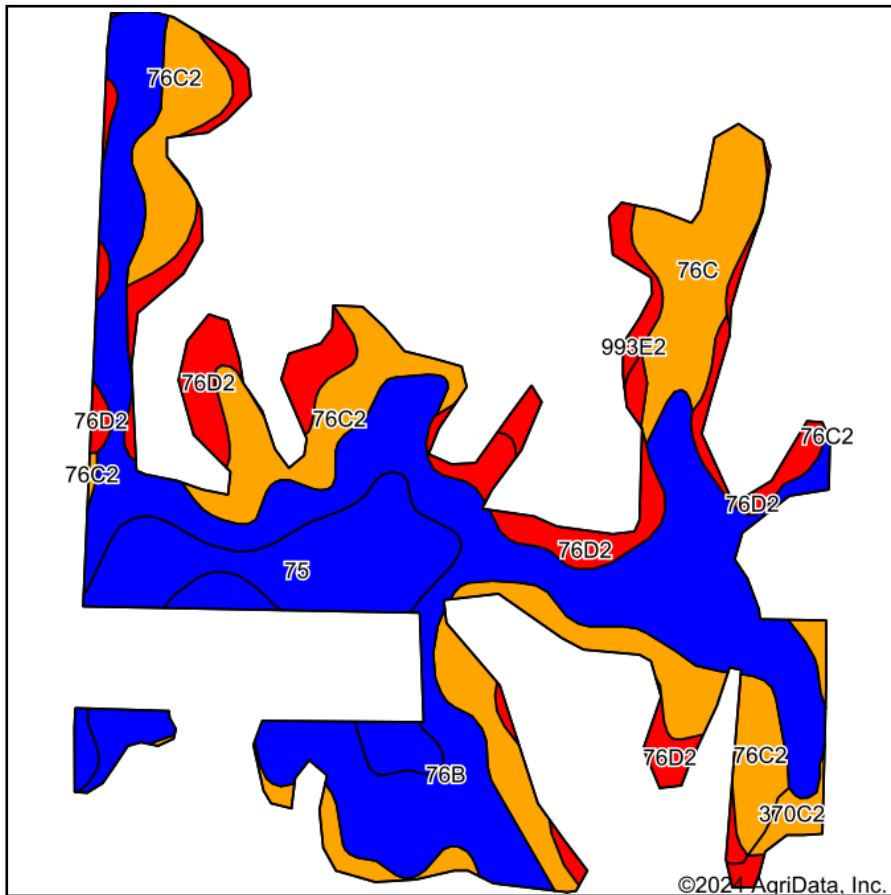

Soils data provided by USDA and NRCS.

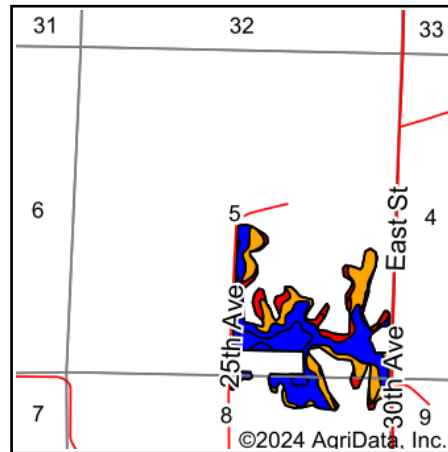

State: **Iowa**  
 County: **Warren**  
 Location: **5-76N-25W**  
 Township: **Jefferson**  
 Acres: **74.96**  
 Date: **4/23/2024**



Maps Provided By:



© AgriData, Inc. 2023

www.AgriDataInc.com



Area Symbol: IA181, Soil Area Version: 29

Code	Soil Description	Acres	Percent of field	CSR2 Legend	Non-Irr Class *c	*i Corn Bu	*i Soybeans Bu	CSR2**	CSR	*n NCCPI Soybeans	
76B	Ladoga silt loam, 2 to 5 percent slopes	31.84	42.5%		Ile	212.8	61.7	86	85	77	
76C2	Ladoga silt loam, dissected till plain, 5 to 9 percent slopes, eroded	16.36	21.8%		IIIe	192.0	55.7	75	65	65	
76D2	Ladoga silt loam, 9 to 14 percent slopes, eroded	9.51	12.7%		IIIe	163.2	47.3	49	55	61	
75	Givin silt loam, 0 to 2 percent slopes	9.02	12.0%		Ile	217.6	63.1	86	85	83	
76C	Ladoga silt loam, dissected till plain, 5 to 9 percent slopes	5.57	7.4%		IIIe	196.8	57.1	80	70	74	
993E2	Armstrong-Gara loams, 14 to 18 percent slopes, moderately eroded	1.38	1.8%		VIe	104.0	30.2	17	5	43	
370C2	Sharpsburg silty clay loam, 5 to 9 percent slopes, eroded	1.05	1.4%		IIIe	204.8	59.4	80	67	66	
Y93D2	Shelby-Adair clay loams, dissected till plain, 9 to 14 percent slopes, eroded	0.23	0.3%		IIIe	0.0	0.0	35		50	
<b>Weighted Average</b>						<b>2.39</b>	<b>198.6</b>	<b>57.6</b>	<b>76.9</b>	<b>*-</b>	<b>*n 72</b>

\*\*IA has updated the CSR values for each county to CSR2.

\*- CSR weighted average cannot be calculated on the current soils data, use prior data version for csr values.\*i Yield data provided by the ISPAID Database version 8.1.1 developed by IA State University.

\*n: The aggregation method is "Weighted Average using all components"

\*c: Using Capabilities Class Dominant Condition Aggregation Method