

(Landowners)

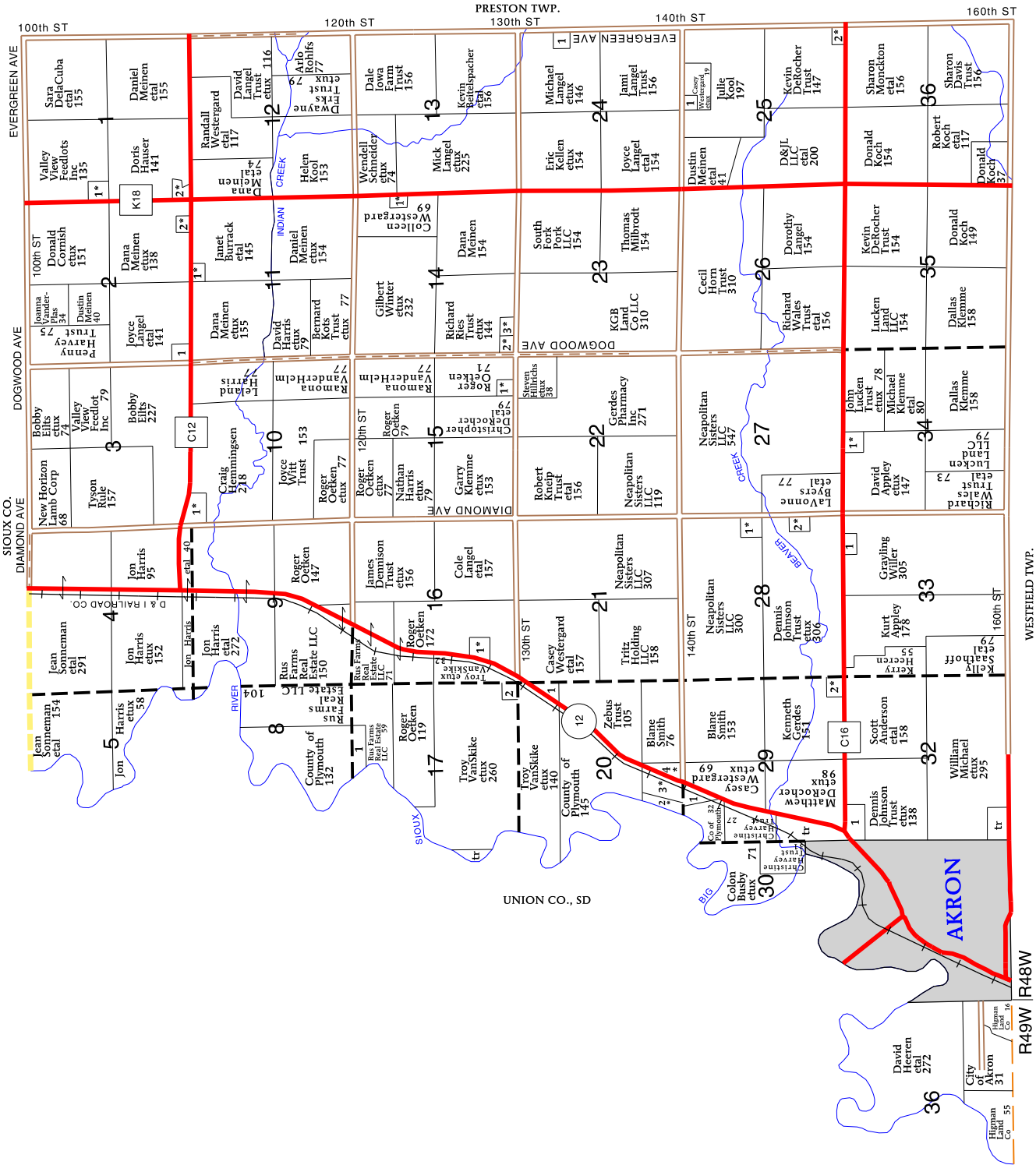

<b>PORTLAND TOWNSHIP</b>
<b>SECTION 1</b>
1 GARRETT, MICHAEL ETUX 14
2 BRUGET, JEROD ETUX 11
<b>SECTION 2</b>
1 GUTHRIDGE, JOHN 10
2 MENEN, DUSTIN ETAL 6
<b>SECTION 10</b>
1 MAHANEY, THOMAS ETUX 12
<b>SECTION 11</b>
1 BURRACK, STEVEN ETUX 9
<b>SECTION 14</b>
1 ROLFES, JASON ETUX 7
2 KLENME, GARRY ETUX 7
3 WOLTHUIZEN, JEFFREY ETUX 8
<b>SECTION 15</b>
1 EYER, JAMES ETUX 6
<b>SECTION 16</b>
1 SCHOENFELDER, NICHOLAS ETUX 12
<b>SECTION 17</b>
1 COUNTY OF PLYMOUTH 15
2 WAKEMAN, GERALD 5
<b>SECTION 20</b>
1 WESTERGARD, CASEY 7
2 BUSBY, COLON ETUX 6
3 HARVEY TRUST, CHRISTINE ETAL 14
4 WESTERGARD, CASEY ETUX 9
<b>SECTION 22</b>
1 JAMGOLA LICAR 12
<b>SECTION 24</b>
1 HEBERT, BECKY 6
<b>SECTION 25</b>
1 GABEL FARMS INC 5
2 SABALOUSKAS, JOHN ETUX 5
<b>SECTION 28</b>
1 HAUSER, NED ETUX 14
2 ARREGOLA, JOSE ETUX 8
<b>SECTION 29</b>
1 HARVEY TRUST, CHRISTINE 5
2 WILLER, AUSTIN ETUX 6
<b>SECTION 32</b>
1 PORTLAND TOWNSHIP CEMETERY 15
<b>SECTION 33</b>
1 JACOBS, LEA 7
<b>SECTION 34</b>
1 ADAMS, RICHARD ETAL 9

