

<b>MADISON TOWNSHIP</b>	<b>SECTION 13W</b>	1 DOTY, SAMANTHA 76 2 DOVEL, CHARLES L E T A L 55 3 NARKUNST, JAMES A E T A L 107	<b>SECTION 17</b>	3 LAUMANN, DAVID E T A L 6.92	<b>SECTION 29</b>	1 WOODWARD TRUST, TERESA M 24.08	<b>SECTION 35W</b>	1 ATHEN, COURTNEY 20.46 2 SPIEGEL, KYLE THOMAS E T A L 8.49 3 GORDEN, A G E F A R M L L C 40.21
<b>SECTION 1E</b>	<b>SECTION 14W</b>	1 GLENN, STEPHEN A E T A L 1467	<b>SECTION 18</b>	1 ATHEN, CRAIG E T A L 2502 2 MCCALL, ROY E T A L 5.95	<b>SECTION 30</b>	1 MADISON TWP CHURCH CEMETERY 9.8 2 MADISON TWP CHURCH CEMETERY 1742 3 MARTIN, HELENE E T A L 28.23	<b>SECTION 36E</b>	1 NOK TRUST, JAMES CHRISTIAN E T A L 52.95
<b>SECTION 2E</b>	<b>SECTION 15W</b>	1 CATLETT, DONALD K E T A L 1085 2 ASTROPE, D A L F A R M S L L C 24.59 3 GARDNER, J E B O R A H L E T A L 2065 4 BRUBAKER, VICKI LYNN 2779	<b>SECTION 22W</b>	1 BARRINGTON, ADAM E T A L 721 2 MORAN, BRUCE 10.92 3 GARDNER, CHARLES E T A L 6.15	<b>SECTION 31</b>	1 SFLANDRO, L L C 56.67 2 LANG, CLAYTON E T A L 16.89	<b>SECTION 38W</b>	1 BAILEY TRUST, WAYNE E T A L 42.87 2 GOSBER, MARILYN E T A L 16.83 3 SFLANDRO, L L C 22.87
<b>SECTION 2W</b>	<b>SECTION 16W</b>	1 WELCHMS, KENNETH CARL 95	<b>SECTION 23E</b>	1 SHEARER, JEFFERIAL 727	<b>SECTION 32</b>	1 WOODWARD TRUST, TERESA M 13.46		
<b>SECTION 5</b>	<b>SECTION 19</b>	1 POLLETT, DARRYL 1146	<b>SECTION 24E</b>	1 ATHEN, COURTNEY E T A L 26.91 2 RONALLA, RANDI L L C 34.36 3 ATHEN, COURTNEY 26.69	<b>SECTION 33</b>	1 WOODWARD TRUST, JOHN T 21.37 2 TOWERVIEW FARMS INC 26.2		
<b>SECTION 8</b>								
<b>SECTION 9</b>								
<b>SECTION 26</b>								
<b>SECTION 35</b>								

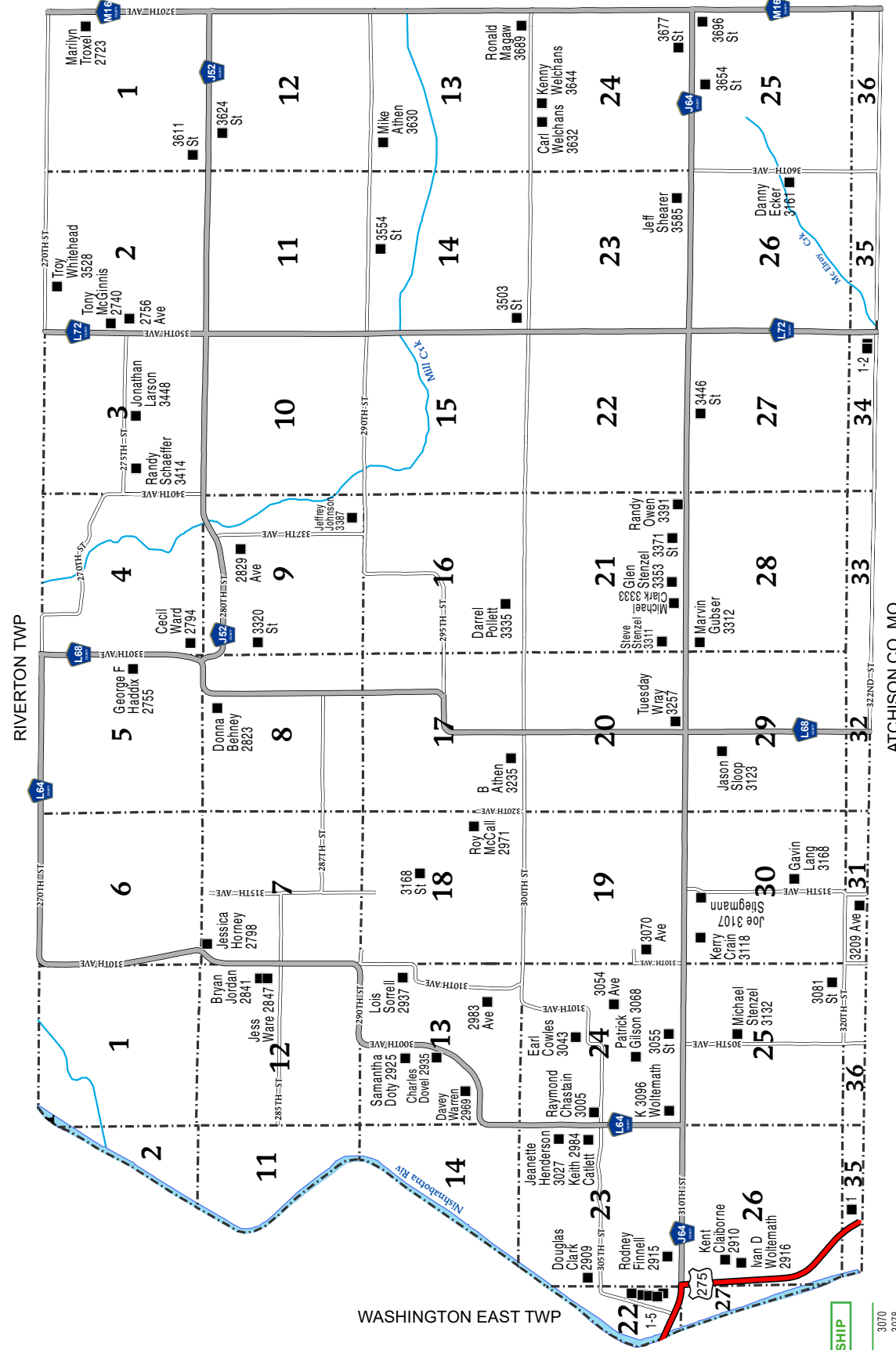

<b>MADISON TOWNSHIP</b>	<b>SECTION 22W</b>	1 MORAN, BRYCE 3070 2 CLARK, DEANNA 3078 3 GARDNER, CHARLES 3080 4 GUDE, MARK 2891 5 HENRICKSON, DREW 2893	<b>SECTION 34</b>	1 BARRETT, CURTIS 3491 2 COWDEN, JOHN 3215
	<b>SECTION 35W</b>	1 SPIEGEL, KYLE 3210		

(Landowners)  
FISHER TWP

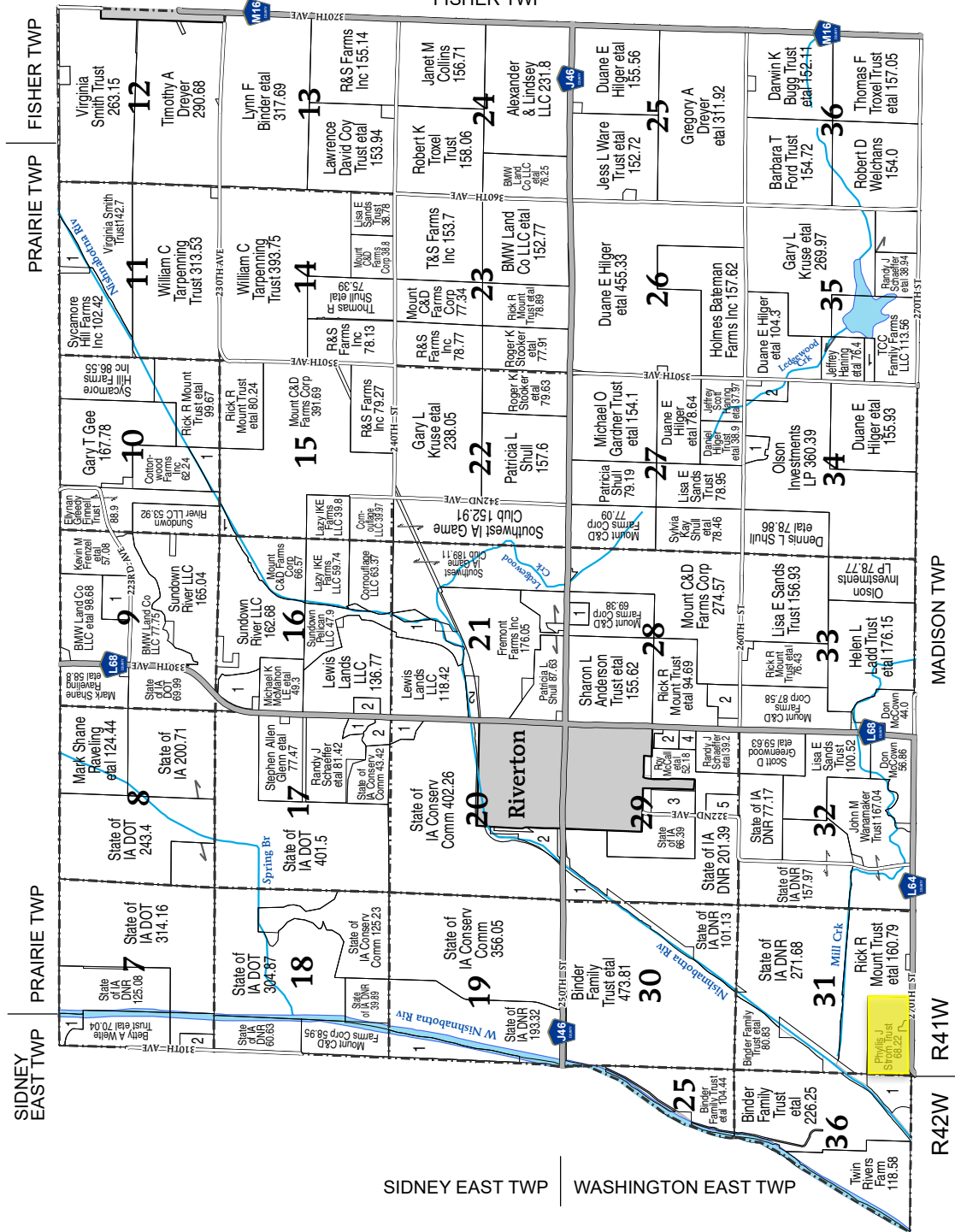

SIDNEY EAST TWP WASHINGTON EAST TWP

R42W R41W

RIVERTON TOWNSHIP	
SECTION 7	1047
1 FORD TRUST, BARBARAT	1025
2 DAWSON, LARRY ETAL	2533
SECTION 9	2533
1 VARELLAS, BRYAN J ETAL	1754
SECTION 10	1754
1 MOUNT C&D FARMS CORP	1722
SECTION 11	1722
1 SANDERS, SHERYL G	616
SECTION 15	616
1 SUNDOWN RIVER LLC	

SECTION 16	2533
1 BIMV LAND CO LLC	949
2 HAUGHTON, RICHARD J ETAL	87
SECTION 17	131
1 FELVER, KENNETH L ETAL	4479
2 STATE OF IA DNR	225
SECTION 19	225
1 MOUNT C&D FARMS CORP	781
SECTION 20	781
1 STATE OF IA DNR	2564
2 STATE OF IA DNR	
SECTION 21	2564
1 SUNDOWN RIVER LLC	

SECTION 28	947
1 MOUNT LE CLINTON RAY ETAL	1958
2 MOUNT TRUST, SHELBY R ETAL	1366
SECTION 29	1366
1 BINDER FAMILY TRUST	965
2 COWDEN, I FRANK ZP ETAL	216
3 SCHAEFFER, TERRY RAY ETAL	934
4 COWDEN, DUANE	1424
5 CITY OF RIVERTON	1171
SECTION 34	1171
1 DIPPEL, MICHAEL R ETAL	1632
2 MOUNT C&D FARMS CORP	

SECTION 35	907
1 CUSICK, CARSON ETAL	908
SECTION 36W	2582
1 WINSLOW TRUST, YVANE ETAL	

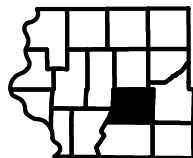

(Residents - Owners or Renters)  
FISHER TWP

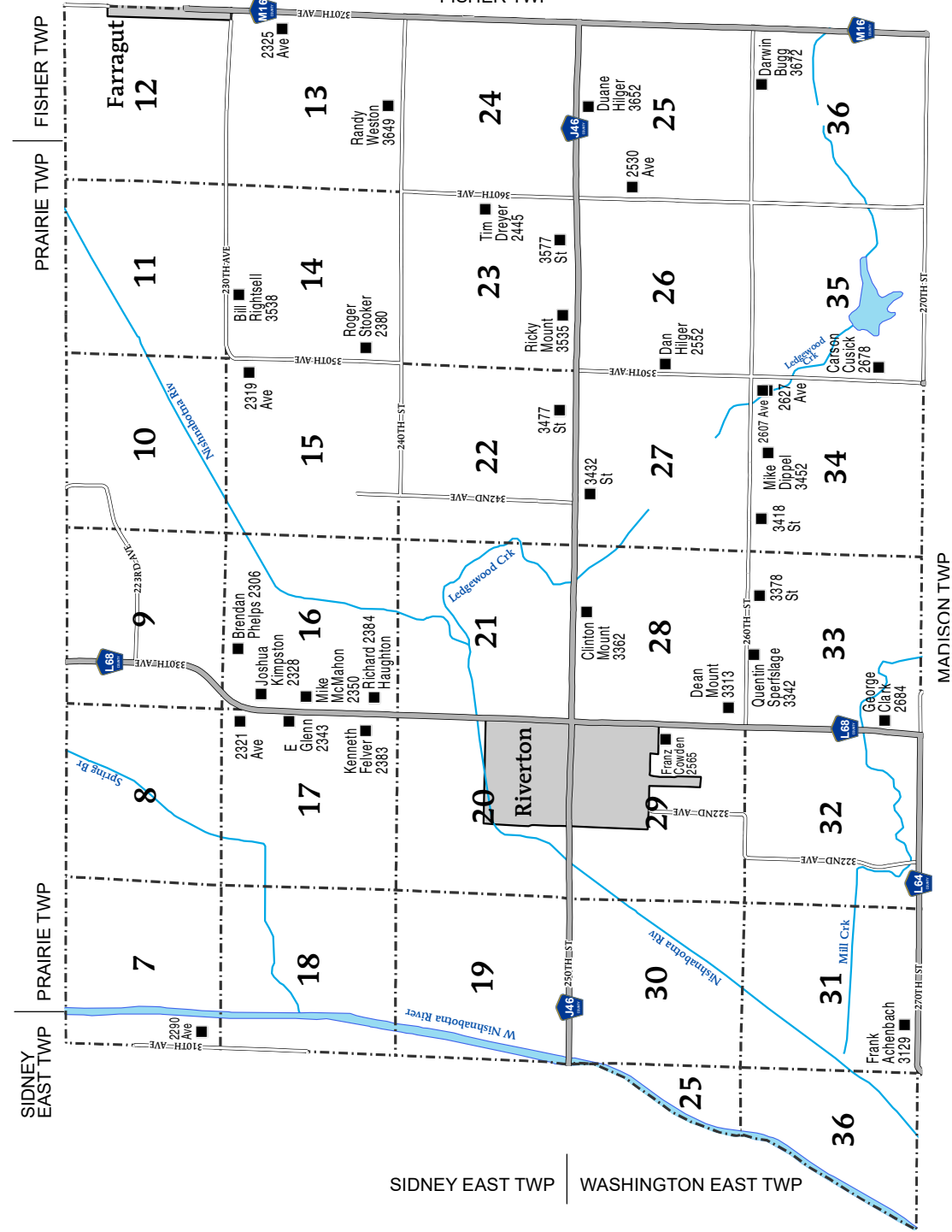

SIDNEY EAST TWP WASHINGTON EAST TWP

MADISON TWP