

(Landowners)
DALLAS CO

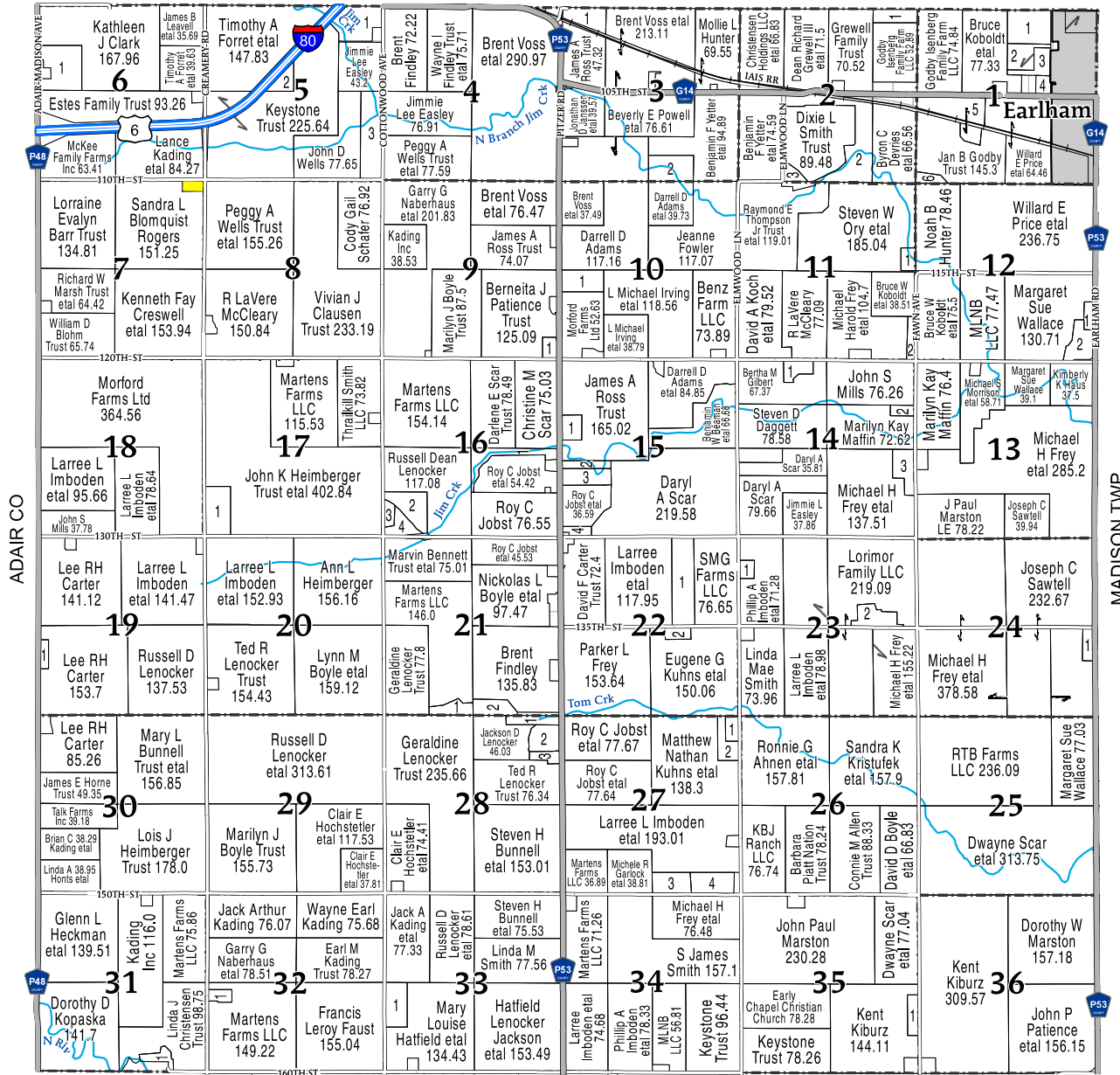

JACKSON TWP

PENN TOWNSHIP

SECTION 1

- 1 EARLHAM COMMUNITY SCHOOL DIST 29.19
- 2 ADAMS, DARRELL D 29.21
- 3 REYNOLDS, DOUGLAS E ETAL 12.06
- 4 KELLER, RACHELLE D ETAL 5.55
- 5 FROMMELT, WILLIAM L ETAL 34.35
- 6 DEVRIES, BYRON C ETAL 5.72

SECTION 2

- 1 HUNTER TRUST, FRED R 11.83
- 2 DEVRIES, BYRON C ETAL 53.92
- 3 FRANK, MICHAEL J ETAL 5.66

SECTION 3

- 1 FERGUSON, CURTIS GENE ETAL 15.94
- 2 ADAMS, DARRELL D ETAL 23.48

SECTION 5

- 1 SCHAFER, EUGENE R ETAL 28.76
- 2 KEYSTONE TRUST 8.44
- 3 HAXTON, ROBERT BRUCE 36.49

SECTION 6

- 1 MARSH TRUST, RICHARD W ETAL 35.36

SECTION 9

- 1 IA POWER & LIGHT 6.21

SECTION 10

- 1 PATIENCE TRUST, BERNEITA J 18.49

SECTION 11

- 1 STANLEY, JACKSON D ETAL 6.69
- 2 ABELS, LEONARD G ETAL 6.57

SECTION 12

- 1 LINN, JEFFREY A ETAL 5.44
- 2 JOHNSTON, JACOB K ETAL 17.07

SECTION 14

- 1 CAMPBELL, ANDREW ETAL 9.51
- 2 STEARNS, DWIGHT ALAN ETAL 5.12
- 3 BOND, DOROTHY E 16.13

SECTION 15

- 1 ROSS, JAMES A 10.09
- 2 OPSETH, GREGORY E ETAL 7.79
- 3 SCAR, NICHOLAS JAMES 16.45
- 4 METHODIST CHURCH & CEMETERY 5.44

SECTION 16

- 1 STEWARD, ERIC A ETAL 19.55
- 2 LENOCKER, RUSSELL D ETAL 21.42
- 3 NEAL, MASON ETAL 5.12
- 4 MASCAR LLC 10.46

SECTION 17

- 1 HEIMBERGER, ANN L 24.09

SECTION 19

- 1 BEELER, AMANDA ETAL 5.43

SECTION 21

- 1 LENOCKER TRUST, GERALDINE 10.36
- 2 STEWARD, ERIC A ETAL 12.78

SECTION 22

- 1 IMBODEN, LARREE L ETAL 39.55
- 2 KUHN, EUGENE G 5.99

SECTION 23

- 1 DONNELLY, THOMAS J ETAL 5.28
- 2 LORIMOR EASLEY, NINA ANN 15.44

SECTION 24

- 1 FREY, MICHAEL H ETAL 7.3

SECTION 27

- 1 STEWARD, ERIC A ETAL 6.51
- 2 KUHN, EUGENE G ETAL 12.35
- 3 COULTER IV, JOHN S ETAL 16.19
- 4 LENOCKER TRUST, TED R 18.3

SECTION 28

- 1 COONS TRUST, JAMES ETAL 9.92
- 2 BEATTY, MARK L ETAL 15.54
- 3 BEATTY, MARK LINCOLN ETAL 6.34

SECTION 31

- 1 SESKER, GENE D ETAL 7.27

SECTION 32

- 1 FAGEN, THOMAS J ETAL 5.76

SECTION 33

- 1 HATFIELD SPRAGUE, DENISE ETAL 19.15

SECTION 35

- 1 BURGER, RYAN EUGENE ETAL 8.96

