

(Landowners)  
BAKER TWP

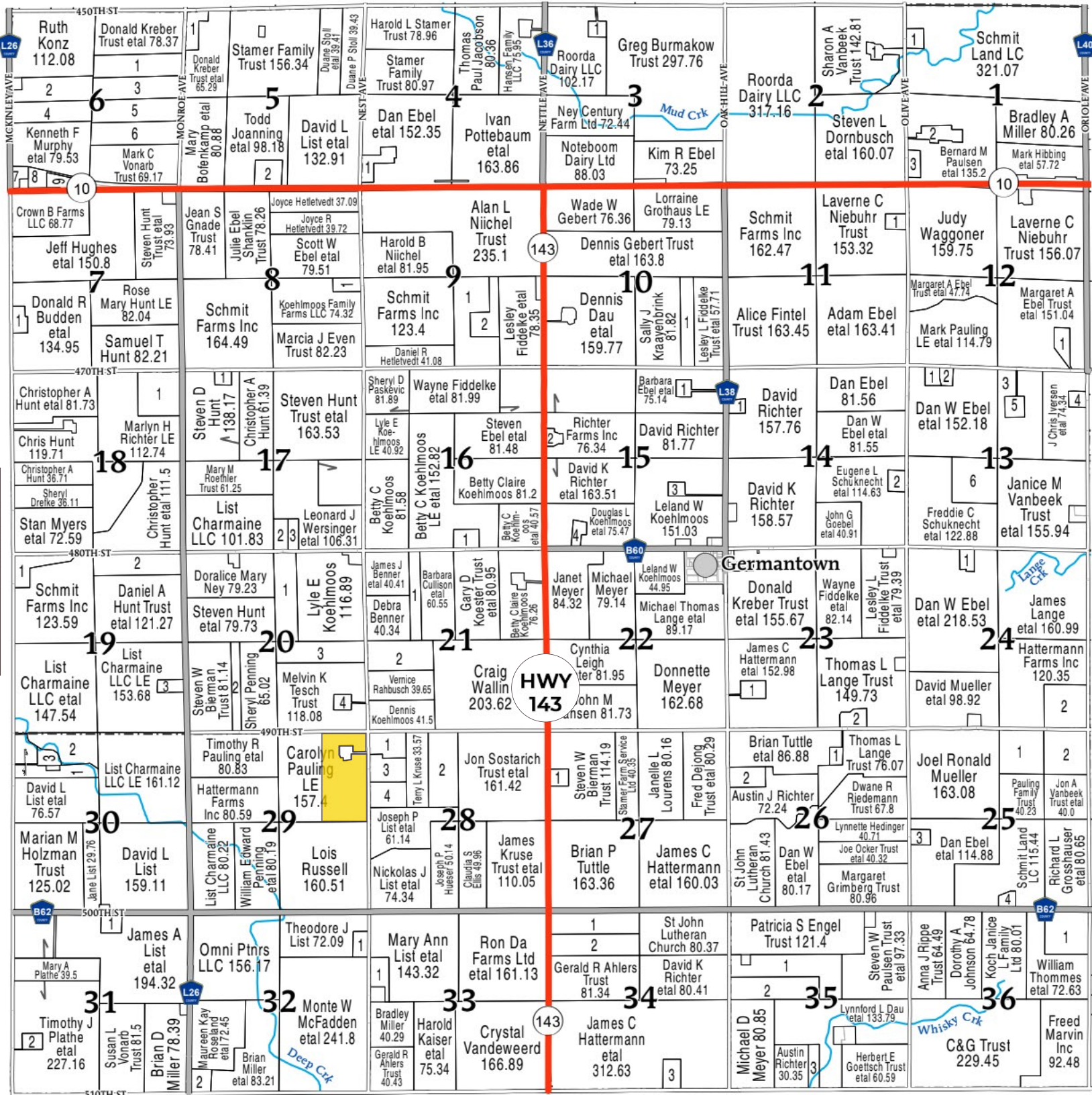

SIoux CO.

UNION TWP

CHEROKEE CO.

**CALEDONIA TOWNSHIP**

**SECTION 1**

1	DAU, CHAD H ETAL	7.45
2	PAULSEN, STEVEN L ETAL	12.82
3	BRADBURY, MARK ETAL	7.6

**SECTION 2**

1	GRIEBEL, DEREK ETAL	16.41
---	---------------------	-------

**SECTION 3**

1	YESKE, JOHN E ETAL	6.21
---	--------------------	------

**SECTION 4**

1	FISCHER, ROGER A ETAL	13.23
---	-----------------------	-------

**SECTION 5**

1	DEBOER, MATTHEW J ETAL	13.43
2	SELLS TRUST, JOHN D	14.62

**SECTION 6**

1	SCHUVER TRUST, GWENDOLYN B	40.01
2	WALGENBACH, ARLENE	37.13
3	MILLER FAMILY FARMS LTD	40.02
4	PENNING, DARYL J ETAL	33.87
5	BOFENKAMP, MARY ETAL	40.72
6	HEYING, LEONARD P	40.74
7	STRUVE TRUST, C&C	6.08
8	BUNKERS FEED & SUPPLY INC	8.52
9	POTTEBAUM, MICHAEL A ETAL	9.21

**SECTION 7**

1	ASCHERL, JOSEPH A ETAL	8.13
---	------------------------	------

**SECTION 8**

1	JALAS, BRAD ETAL	8
---	------------------	---

**SECTION 9**

1	NIEUWENHUIS, JAMES WILLIAM ETAL	61.23
2	FIDDELKE TRUST, LESLEY L ETAL	20.81

**SECTION 10**

1	EBEL, SCOTT W ETAL	24
---	--------------------	----

**SECTION 11**

1	EBEL, DAN W ETAL	6.68
---	------------------	------

**SECTION 12**

1	HURTIG, TRAVIS W	9.74
---	------------------	------

**SECTION 13**

1	EBEL, LEE A ETAL	5.86
2	FINTEL, RANDY A	5.01
3	KOEHLMOOS TRUST, BETTY L	71.82
4	ANDERSON, WALTER	6.04
5	PAULSEN, PAT ETAL	8.71
6	SCHUKNECHT, EUGENE L ETAL	40.91

**SECTION 14**

1	ROORDA, SCOTT C ETAL	5.27
2	SCHUKNECHT, FRED ETAL	7.95

**SECTION 15**

1	CORCORAN, EDWARD C ETAL	6.4
2	THIEL, ROBERT ETAL	5.47
3	CULLISON, JERRY E ETAL	5.8
4	KOEHLMOOS, DOUGLAS ETAL	6.41

**SECTION 16**

1	VOSS, DALE ETAL	10.31
---	-----------------	-------

**SECTION 17**

1	HUNT, JUSTIN	5
2	AHLERS, RANDALL	9.47
3	ANDRESEN, SKYLER JOHN	6.53

**SECTION 18**

1	ZEUTENHORST, CHRISTINE L	38.34
---	--------------------------	-------

**SECTION 19**

1	RINEHART, MATTHEW RAY ETAL	20.17
2	HUNT, CHRISTOPHER A	40.5
3	LIST TRUST, DALE JOSEPH	7.33

**SECTION 20**

1	KOEHLMOOS LE, LYLE E	40.55
2	PENNING, WILLIAM E ETAL	16.14
3	WALGENBACH, JACOB D ETAL	38.49
4	TESCH, TERRY L ETAL	5.75

**SECTION 21**

1	BENNER, DEBRA ETAL	20.17
2	KIRCHNER TRUST, SUSAN K	39.83

**SECTION 23**

1	HATTERMANN FARMS INC	9.28
2	LANGE, MICHAEL ETAL	9.94

**SECTION 24**

1	EBEL, ADAM D	6.62
2	HATTERMANN, TODD J	39.21

**SECTION 25**

1	HATTERMANN, TODD J ETAL	40.05
2	HATTERMANN, TODD	39.82
3	LINGEN RODRIGUES, MARQUES J ETAL	6.58
4	GROEPPER, PERRY D ETAL	5.62

**SECTION 26**

1	GOEBEL, BAILEY J	5.1
2	ROORDA, SCOTT	15

**SECTION 27**

1	SWINE LAKE LLC	6.89
---	----------------	------

**SECTION 28**

1	DURST, SHERRY L	19.05
2	SAND CHUCK FAMILY FARMS LLC	44.93
3	KRUSE, TERRY L ETAL	19.14
4	TESCH, THOMAS ETAL	19.2

**SECTION 30**

1	PAULSEN TRUST, RON ETAL	32.51
2	BUNKERS FEED & SUPPLY INC	34.43
3	PAULSEN, SCOTT W ETAL	7.38

**SECTION 31**

1	LIST, THEODORE J	8.44
2	AHLERS, RANDALL ETAL	6.67

**SECTION 32**

1	VANIPEREN, MICHAEL ETAL	8.21
2	MILLER TRUST	10.7

**SECTION 33**

1	LIST, THEODORE	12.92
---	----------------	-------

**SECTION 34**

1	KRUSE TRUST, JAMES ETAL	42.64
2	KRUSE, DORIS	39.3
3	HATTERMANN FARMS INC	11.09

**SECTION 35**

1	LANGE, MICHAEL THOMAS ETAL	58.73
2	HATTERMANN, JEFFERY ETAL	40.48
3	MEYER, DONNETTE	10.05

**SECTION 36**

1	THOMMES LE, JOAN R ETAL	40.22
---	-------------------------	-------

