

Soils Map

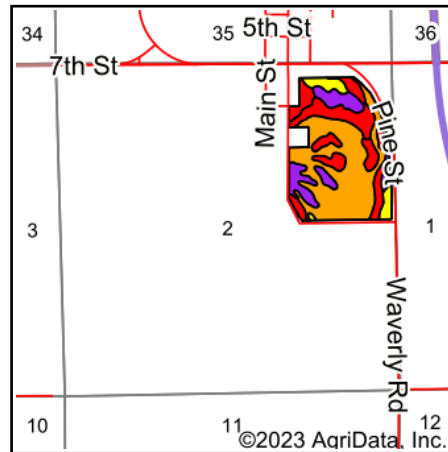

State: **Iowa**
 County: **Black Hawk**
 Location: **2-90N-14W**
 Township: **Washington**
 Acres: **71.96**
 Date: **8/29/2023**



Maps Provided By:

 CUSTOMIZED ONLINE MAPPING
 © AgriData, Inc. 2023 www.AgriDataInc.com



Soils data provided by USDA and NRCS.

Area Symbol: IA013, Soil Area Version: 30

Code	Soil Description	Acres	Percent of field	CSR2 Legend	Non-Irr Class *c	Irr Class *c	*i Corn Bu	*i Soybeans Bu	CSR2**	CSR	*n NCCPI Soybeans
485	Spillville loam, 0 to 2 percent slopes, occasionally flooded	35.99	50.0%		IIw		208.0	60.3	76	92	74
159C	Finchford loamy sand, 2 to 9 percent slopes	9.38	13.0%		IVs		132.8	38.5	33	5	21
284	Flagler sandy loam, 0 to 2 percent slopes	9.30	12.9%		IIIs		80.0	23.2	55	50	37
159	Finchford loamy sand, 0 to 2 percent slopes	5.33	7.4%		IVs		148.8	43.2	44	30	24
41	Sparta loamy fine sand, 0 to 2 percent slopes	3.23	4.5%		IVs	IIe	148.8	43.2	44	45	30
178B	Waukee loam, 2 to 5 percent slopes	2.54	3.5%		IIs		80.0	23.2	64	74	68
178	Waukee loam, 0 to 2 percent slopes	1.96	2.7%		IIs		80.0	23.2	69	79	70
41C	Sparta loamy fine sand, 5 to 9 percent slopes	1.68	2.3%		IVs	IIe	124.8	36.2	34	25	30
175	Dickinson fine sandy loam, 0 to 2 percent slopes	1.44	2.0%		IIIs		80.0	23.2	55	60	37
41B	Sparta loamy fine sand, 2 to 5 percent slopes	1.11	1.5%		IVs	IIe	140.8	40.8	39	40	30
Weighted Average							161.1	46.7	61.3	64.5	*n 53.9

**IA has updated the CSR values for each county to CSR2.

*i Yield data provided by the ISPAID Database version 8.1.1 developed by IA State University.

*n: The aggregation method is "Weighted Average using all components"

*c: Using Capabilities Class Dominant Condition Aggregation Method

*- Irr Class weighted average cannot be calculated on the current soils data due to missing data.

Soils data provided by USDA and NRCS.