

# Soils Map

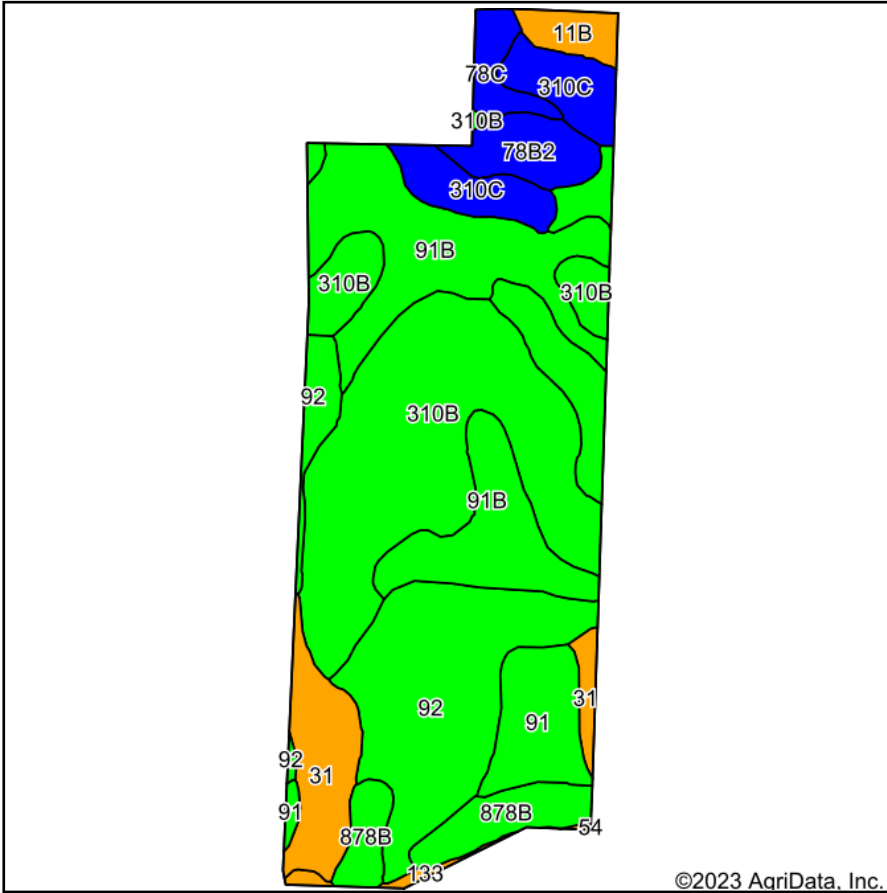

©2023 AgriData, Inc.

Soils data provided by USDA and NRCS.

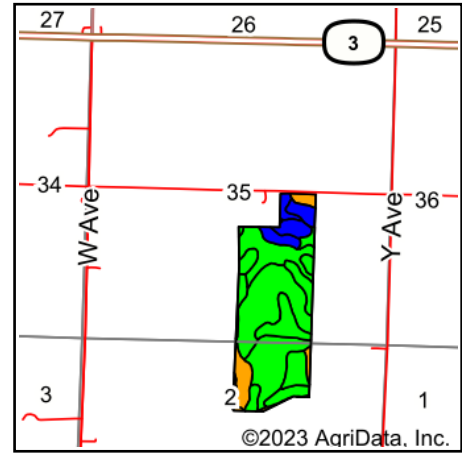

State: **Iowa**  
 County: **Cherokee**  
 Location: **35-92N-39W**  
 Township: **Afton**  
 Acres: **102.53**  
 Date: **8/21/2023**



Maps Provided By:  
  
 CUSTOMIZED ONLINE MAPPING  
 © AgriData, Inc. 2023 [www.AgriDataInc.com](http://www.AgriDataInc.com)



Area Symbol: IA035, Soil Area Version: 32

Code	Soil Description	Acres	Percent of field	CSR2 Legend	Non-Irr Class *c	CSR2**	CSR	*n NCCPI Overall	*n NCCPI Corn	*n NCCPI Small Grains	*n NCCPI Soybeans	
310B	Galva silty clay loam, 2 to 5 percent slopes	29.54	28.8%		IIe	95	71	75	74	59	75	
92	Marcus silty clay loam, 0 to 2 percent slopes	21.94	21.4%		IIw	94	76	75	74	57	75	
91B	Primghar silty clay loam, 2 to 5 percent slopes	19.75	19.3%		IIe	95	79	78	74	61	78	
31	Afton silty clay loam, 0 to 2 percent slopes, occasionally flooded	6.51	6.3%		IIw	80	73	67	64	47	67	
310C	Galva silty clay loam, 5 to 9 percent slopes	6.25	6.1%		IIIe	87	56	77	75	61	77	
91	Primghar silty clay loam, 0 to 2 percent slopes	5.38	5.2%		Iw	100	81	78	74	60	78	
878B	Ocheyedan loam, 2 to 5 percent slopes	5.17	5.0%		IIe	91	61	80	80	58	76	
78B2	Sac silty clay loam, 2 to 5 percent slopes, eroded	3.53	3.4%		IIe	86	65	71	71	49	66	
78C	Sac silty clay loam, 5 to 9 percent slopes	2.01	2.0%		IIIe	84	52	73	73	56	72	
11B	Colo-Judson silty clay loams, 0 to 5 percent slopes, occasionally flooded	1.82	1.8%		IIw	80	59	87	85	49	81	
133	Colo silty clay loam, deep loess, 0 to 2 percent slopes, occasionally flooded	0.63	0.6%		IIw	78	74	81	75	34	80	
<b>Weighted Average</b>						<b>2.03</b>	<b>92.5</b>	<b>72.1</b>	<b>*n 75.7</b>	<b>*n 73.8</b>	<b>*n 57.6</b>	<b>*n 75.2</b>

\*\*IA has updated the CSR values for each county to CSR2.

\*n: The aggregation method is "Weighted Average using all components"

\*c: Using Capabilities Class Dominant Condition Aggregation Method

Soils data provided by USDA and NRCS.