

Soils Map

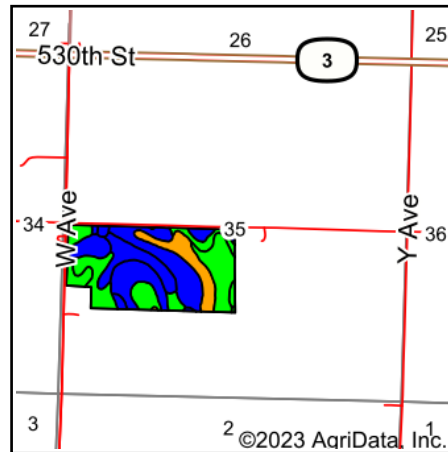

State: **Iowa**
 County: **Cherokee**
 Location: **35-92N-39W**
 Township: **Afton**
 Acres: **74.09**
 Date: **8/21/2023**

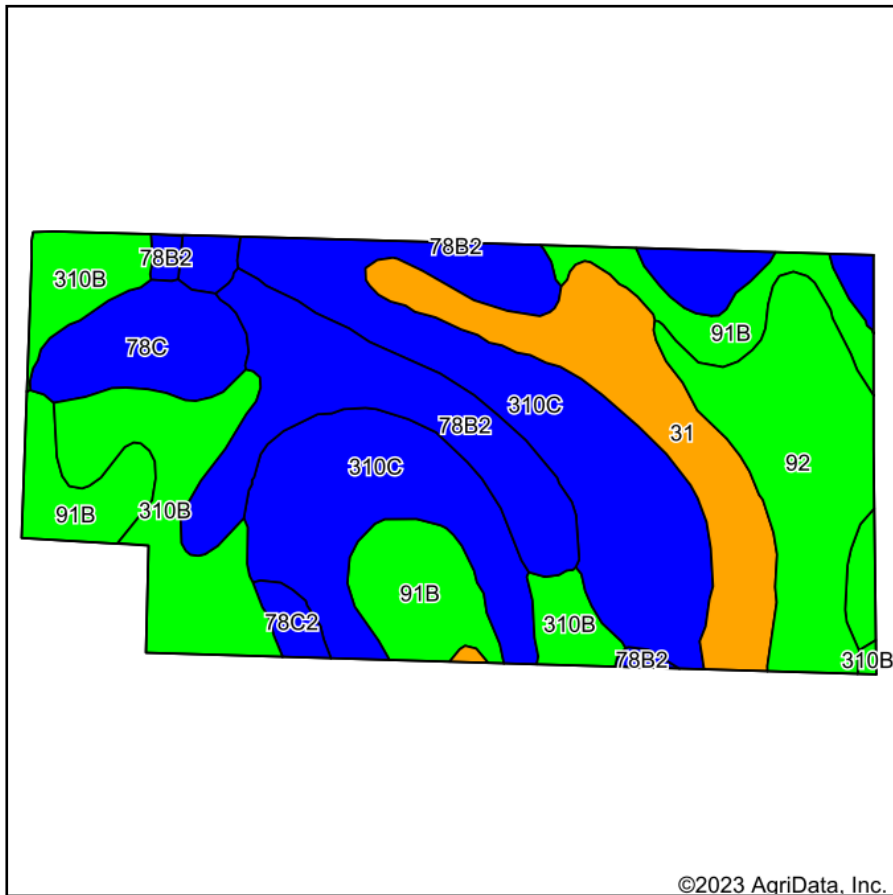

Maps Provided By:

 CUSTOMIZED ONLINE MAPPING
 © AgriData, Inc. 2023 www.AgriDataInc.com



Soils data provided by USDA and NRCS.

Area Symbol: IA035, Soil Area Version: 32

Code	Soil Description	Acres	Percent of field	CSR2 Legend	Non-Irr Class *c	CSR2**	CSR	*n NCCPI Overall	*n NCCPI Corn	*n NCCPI Small Grains	*n NCCPI Soybeans	
310C	Galva silty clay loam, 5 to 9 percent slopes	23.04	31.1%		IIIe	87	56	77	75	61	77	
310B	Galva silty clay loam, 2 to 5 percent slopes	10.16	13.7%		Ile	95	71	75	74	59	75	
91B	Primghar silty clay loam, 2 to 5 percent slopes	9.53	12.9%		Ile	95	79	78	74	61	78	
92	Marcus silty clay loam, 0 to 2 percent slopes	9.08	12.3%		IIw	94	76	75	74	57	75	
78B2	Sac silty clay loam, 2 to 5 percent slopes, eroded	8.54	11.5%		Ile	86	65	71	71	49	66	
31	Afton silty clay loam, 0 to 2 percent slopes, occasionally flooded	8.24	11.1%		IIw	80	73	67	64	47	67	
78C	Sac silty clay loam, 5 to 9 percent slopes	4.11	5.5%		IIIe	84	52	73	73	56	72	
78C2	Sac silty clay loam, 5 to 9 percent slopes, eroded	0.74	1.0%		IIIe	82	50	70	70	49	66	
577B2	Everly clay loam, 2 to 5 percent slopes, moderately eroded	0.65	0.9%		Ile	88	59	75	75	47	65	
Weighted Average						2.38	88.9	66.1	*n 74.5	*n 72.8	*n 56.8	*n 73.7

**IA has updated the CSR values for each county to CSR2.

*n: The aggregation method is "Weighted Average using all components"

*c: Using Capabilities Class Dominant Condition Aggregation Method

Soils data provided by USDA and NRCS.