

Soils Map

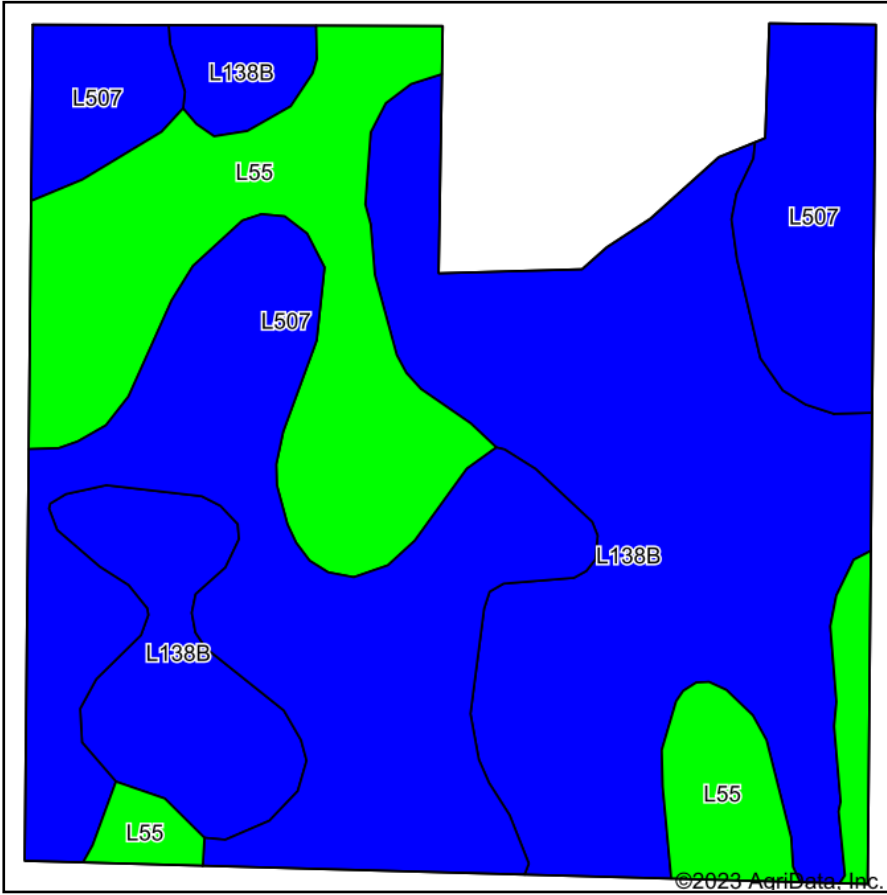

Soils data provided by USDA and NRCS.

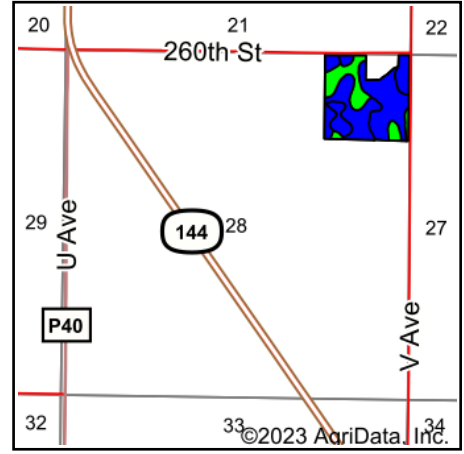

State: **Iowa**
 County: **Greene**
 Location: **28-83N-29W**
 Township: **Washington**
 Acres: **34.79**
 Date: **7/5/2023**





Maps Provided By:

 CUSTOMIZED ONLINE MAPPING
 © AgriData, Inc. 2023 www.AgriDataInc.com

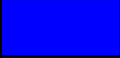

Area Symbol: IA073, Soil Area Version: 28

Code	Soil Description	Acres	Percent of field	CSR2 Legend	Non-Irr Class *c	CSR2**	*n NCCPI Overall	*n NCCPI Corn	*n NCCPI Small Grains	*n NCCPI Soybeans	
L138B	Clarion loam, Bemis moraine, 2 to 6 percent slopes	14.53	41.8%		Ile	88	79	75	60	79	
L507	Canisteo clay loam, Bemis moraine, 0 to 2 percent slopes	12.47	35.8%		Ilw	87	81	70	55	81	
L55	Nicollet loam, 1 to 3 percent slopes	7.79	22.4%		le	91	84	77	63	84	
Weighted Average						1.78	88.3	*n 80.8	*n 73.7	*n 58.9	*n 80.8

**IA has updated the CSR values for each county to CSR2.

*n: The aggregation method is "Weighted Average using all components"

*c: Using Capabilities Class Dominant Condition Aggregation Method

Soils data provided by USDA and NRCS.