

Soils Map

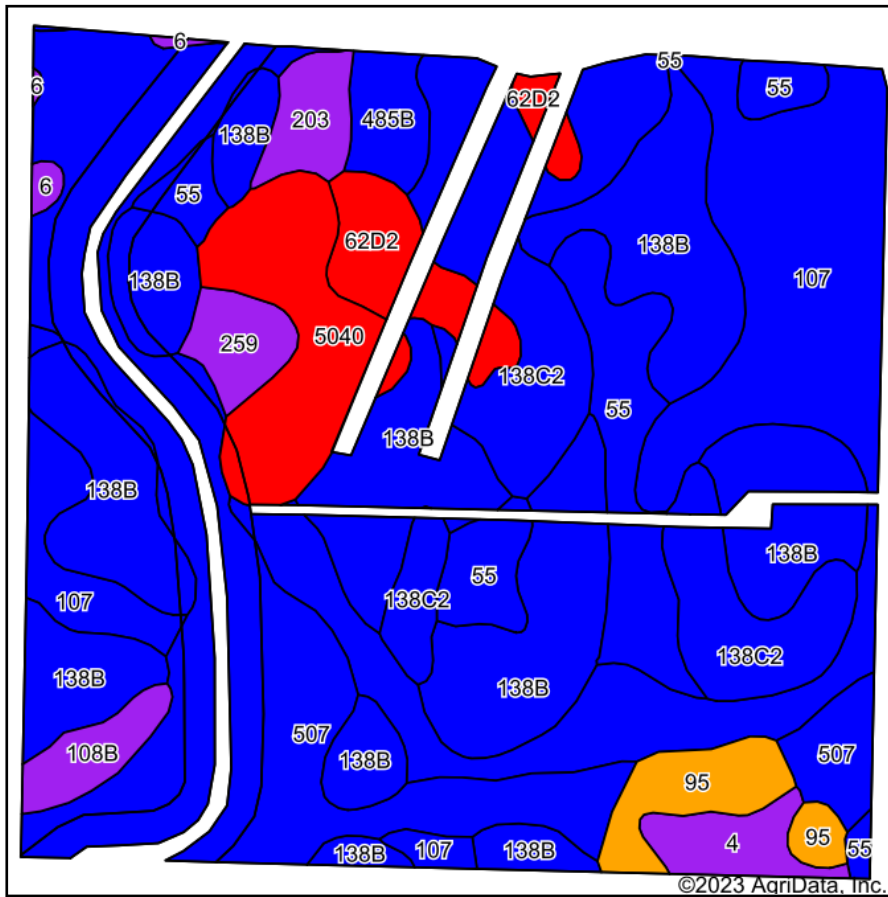

Soils data provided by USDA and NRCS.

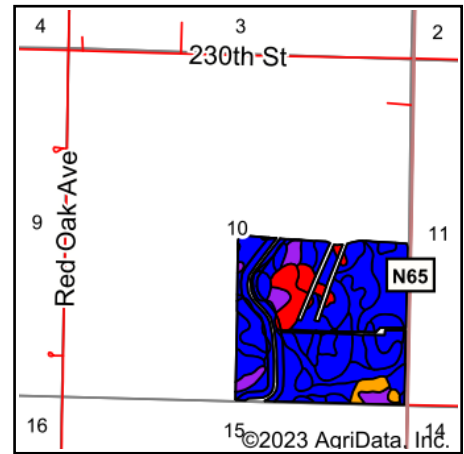

State: **Iowa**
 County: **Calhoun**
 Location: **10-88N-32W**
 Township: **Center**
 Acres: **139.39**
 Date: **5/31/2023**



Maps Provided By:

 CUSTOMIZED ONLINE MAPPING
 © AgriData, Inc. 2023 www.AgriDataInc.com



Area Symbol: IA025, Soil Area Version: 32

Code	Soil Description	Acres	Percent of field	CSR2 Legend	Non-Irr Class *c	CSR2**	CSR	*n NCCPI Overall	*n NCCPI Corn	*n NCCPI Small Grains	*n NCCPI Soybeans
138B	Clarion loam, 2 to 6 percent slopes	36.80	26.4%		Ile	89	80	83	78	62	83
507	Canisteo clay loam, 0 to 2 percent slopes	26.68	19.1%		IIlw	84	78	81	71	56	81
107	Webster clay loam, 0 to 2 percent slopes	25.31	18.2%		IIlw	86	83	82	78	60	82
138C2	Clarion loam, 6 to 10 percent slopes, moderately eroded	15.86	11.4%		IIIle	83	63	70	68	52	70
55	Nicollet clay loam, 1 to 3 percent slopes	9.60	6.9%		Iw	89	88	81	81	64	81
5040	Orthents, loamy	7.29	5.2%			5	5				
62D2	Storden loam, 10 to 16 percent slopes, moderately eroded	3.96	2.8%		IVe	41	42	65	62	46	65
95	Harps clay loam, 0 to 2 percent slopes	3.48	2.5%		IIlw	72	62	82	70	54	82
4	Knoke silty clay loam, 0 to 1 percent slopes	2.13	1.5%		IIIw	56	52	75	35	22	74
485B	Spillville loam, 2 to 5 percent slopes	2.03	1.5%		Ile	88	81	89	87	68	87
203	Cylinder loam, 0 to 2 percent slopes	2.01	1.4%		Ils	58	76	72	72	56	65
259	Biscay clay loam, 0 to 2 percent slopes	1.95	1.4%		IIlw	52	75	69	69	51	66
108B	Wadena loam, 2 to 6 percent slopes	1.84	1.3%		Ile	52	49	62	62	51	51
6	Okoboji silty clay loam, 0 to 1 percent slopes	0.45	0.3%		IIIw	59	57	76	74	64	74
Weighted Average					*-	78.6	72.3	*n 75.3	*n 70	*n 54.7	*n 74.9

**IA has updated the CSR values for each county to CSR2.

*n: The aggregation method is "Weighted Average using all components"

*c: Using Capabilities Class Dominant Condition Aggregation Method

*- Non Irr Class weighted average cannot be calculated on the current soils data due to missing data.

Soils data provided by USDA and NRCS.