

Soils Map

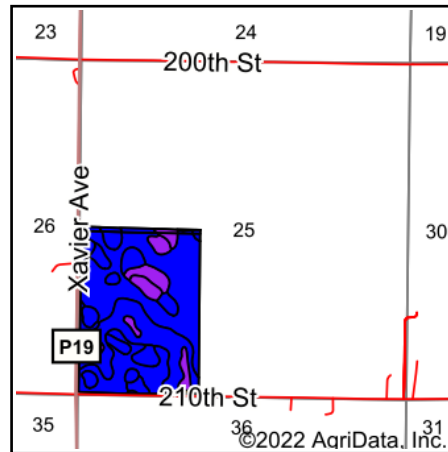

State: **Iowa**
 County: **Calhoun**
 Location: **25-89N-31W**
 Township: **Lincoln**
 Acres: **111.88**
 Date: **8/31/2022**

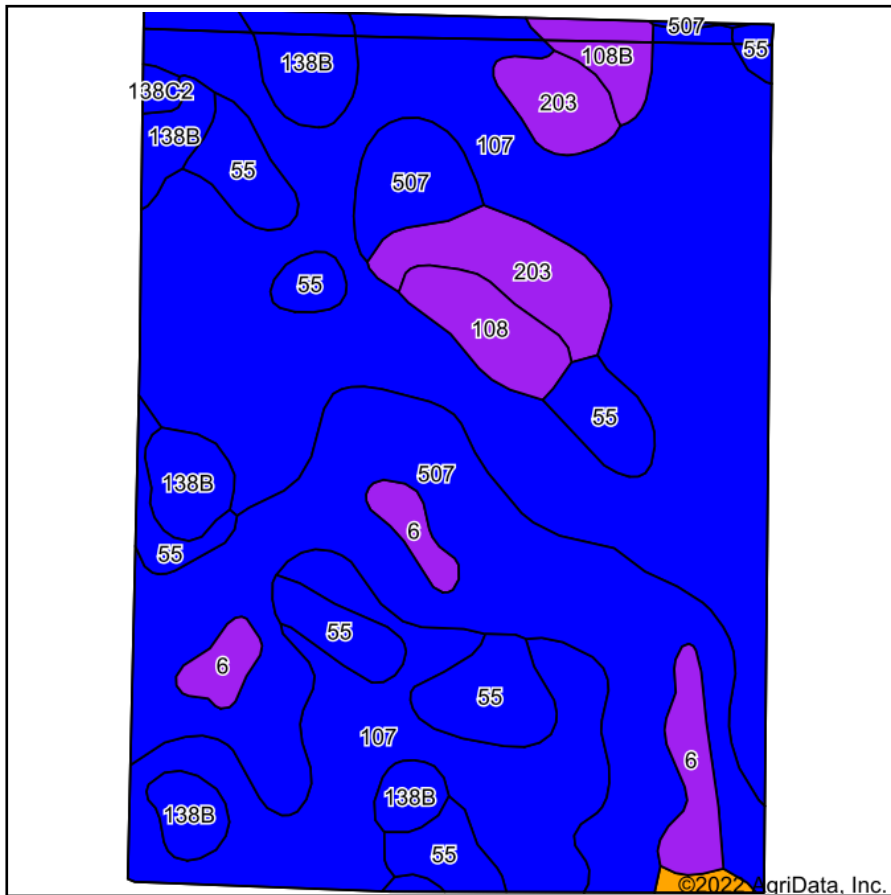

Maps Provided By:

 CUSTOMIZED ONLINE MAPPING
 © AgriData, Inc. 2021 www.AgriDataInc.com



Soils data provided by USDA and NRCS.

Area Symbol: IA025, Soil Area Version: 31

Code	Soil Description	Acres	Percent of field	CSR2 Legend	Non-Irr Class *c	CSR2**	CSR	Oats Bu	Spring wheat Bu	*n NCCPI Overall	*n NCCPI Corn	*n NCCPI Small Grains	*n NCCPI Soybeans	
107	Webster clay loam, 0 to 2 percent slopes	56.75	50.7%		llw	86	83			83	78	60	82	
507	Canisteo clay loam, 0 to 2 percent slopes	25.26	22.6%		llw	84	78			81	71	56	81	
55	Nicollet clay loam, 1 to 3 percent slopes	10.16	9.1%		lw	89	88			82	81	64	82	
138B	Clarion loam, 2 to 6 percent slopes	6.54	5.8%		lle	89	80			84	80	63	84	
203	Cylinder loam, 0 to 2 percent slopes	5.17	4.6%		lls	58				73	73	57	66	
6	Okoboji silty clay loam, 0 to 1 percent slopes	3.56	3.2%		lllw	59	57			76	74	64	74	
108	Wadena loam, 0 to 2 percent slopes	2.34	2.1%		lls	56	54			64	64	52	54	
108B	Wadena loam, 2 to 6 percent slopes	1.41	1.3%		lle	52	49	4	2	64	64	52	53	
95	Harps clay loam, 0 to 2 percent slopes	0.37	0.3%		llw	72	62			82	70	54	82	
138C2	Clarion loam, 6 to 10 percent slopes, moderately eroded	0.32	0.3%		llle	83	63			73	71	54	73	
Weighted Average						1.94	82.7	*-	0.1	*-	*n 81.2	*n 75.9	*n 59.3	*n 79.9

**IA has updated the CSR values for each county to CSR2.

*- CSR weighted average cannot be calculated on the current soils data, use prior data version for csr values.

*n: The aggregation method is "Weighted Average using all components"

*c: Using Capabilities Class Dominant Condition Aggregation Method

Soils data provided by USDA and NRCS.