

# Soils Map

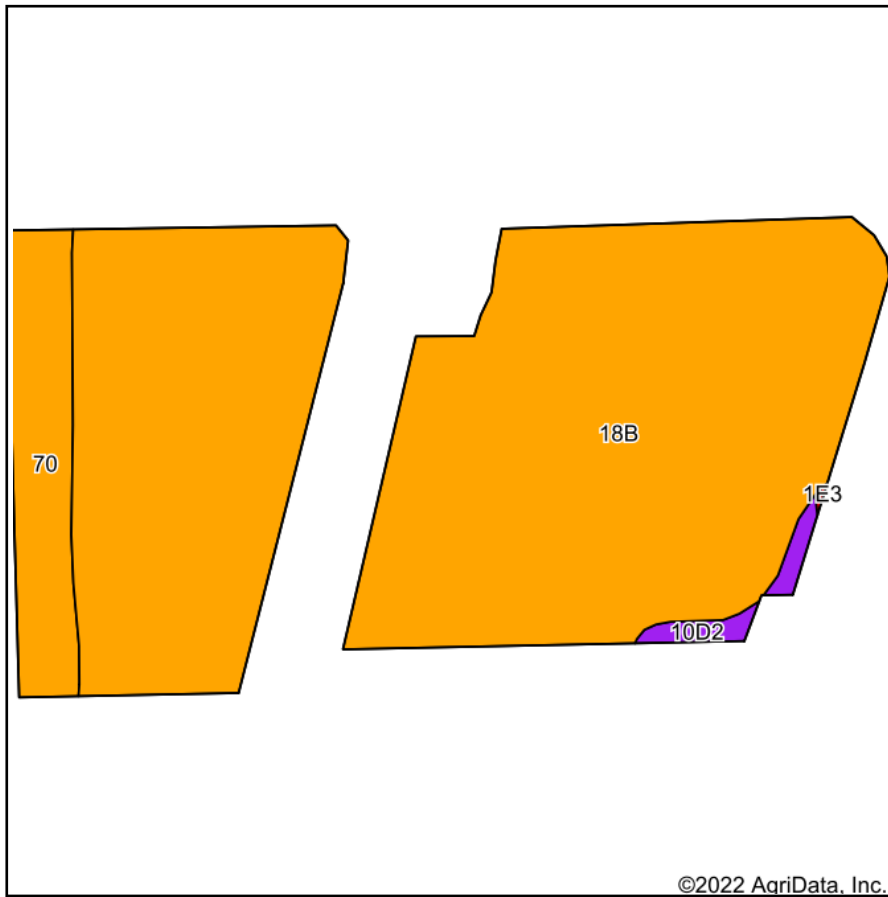

Soils data provided by USDA and NRCS.

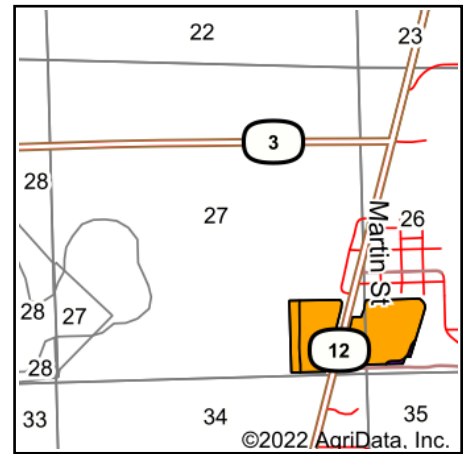

State: **Iowa**  
 County: **Plymouth**  
 Location: **27-92N-49W**  
 Township: **Westfield**  
 Acres: **50.7**  
 Date: **6/22/2022**



Maps Provided By:



Area Symbol: IA149, Soil Area Version: 32

Code	Soil Description	Acres	Percent of field	CSR2 Legend	Non-Irr Class *c	CSR2**	CSR	*n NCCPI Overall	*n NCCPI Corn	*n NCCPI Small Grains	*n NCCPI Soybeans
18B	McPaul-Kennebec silt loams, 2 to 5 percent slopes	45.39	89.5%		Ile	75	70	82	74	44	77
70	McPaul silt loam, 0 to 2 percent slopes	4.62	9.1%		Iw	72	75	75	53	27	75
10D2	Monona silt loam, 9 to 14 percent slopes, eroded	0.69	1.4%		IIIle	60	47	79	79	64	73
Weighted Average					1.92	74.5	70.1	*n 81.3	*n 72.2	*n 42.7	*n 76.8

\*\*IA has updated the CSR values for each county to CSR2.

\*n: The aggregation method is "Weighted Average using all components"

\*c: Using Capabilities Class Dominant Condition Aggregation Method

Soils data provided by USDA and NRCS.