

Soils Map

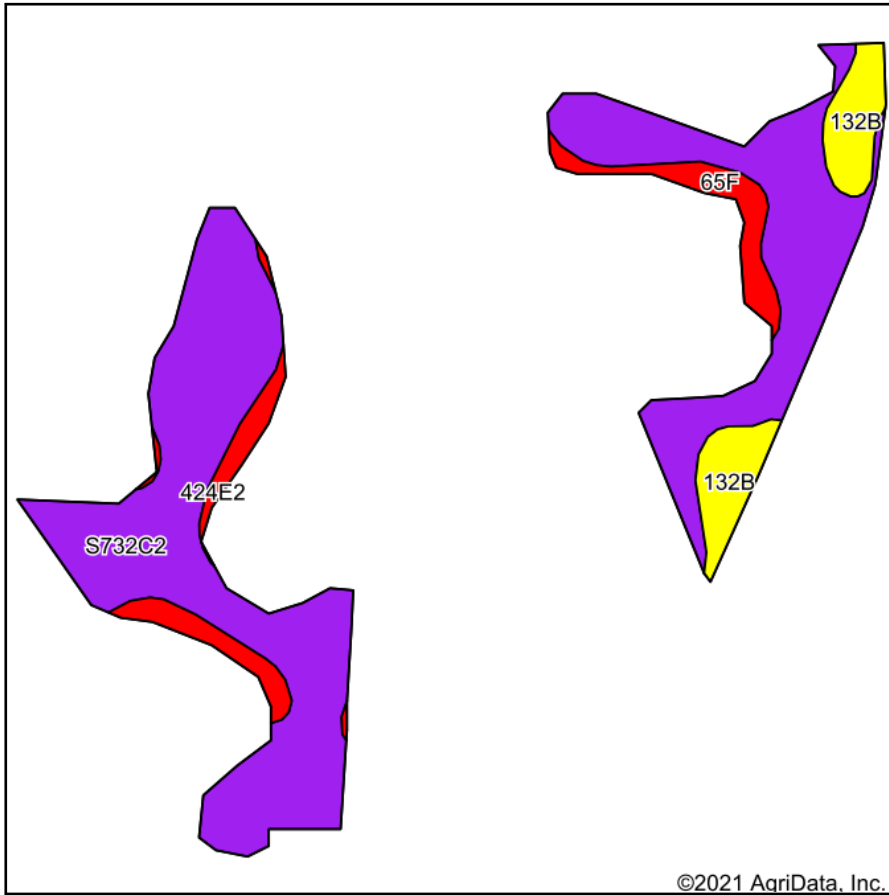

Soils data provided by USDA and NRCS.

©2021 AgriData, Inc.

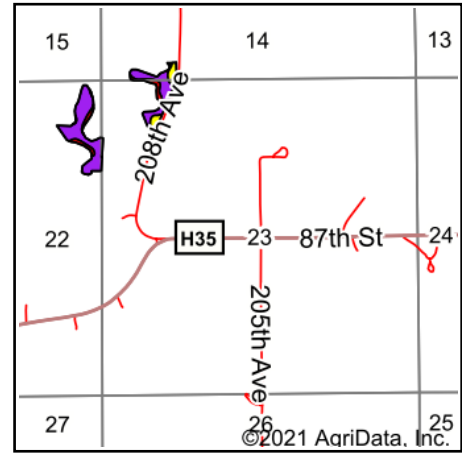

State: **Iowa**
 County: **Wapello**
 Location: **22-72N-15W**
 Township: **Polk**
 Acres: **16.45**
 Date: **11/19/2021**



Maps Provided By:



© AgriData, Inc. 2021

www.AgriDataInc.com



Area Symbol: IA179, Soil Area Version: 30

Code	Soil Description	Acres	Percent of field	CSR2 Legend	Non-Irr Class *c	*i Corn Bu	*i Soybeans Bu	CSR2**	CSR	*n NCCPI Soybeans	
S732C2	Weller silty clay loam, 5 to 9 percent slopes, moderately eroded	12.89	78.4%		IIIe	0	0	59		71	
132B	Weller silt loam, 2 to 5 percent slopes	1.67	10.2%		IIIe	80	23.2	67	55	84	
424E2	Lindley-Keswick loams, 14 to 18 percent slopes, moderately eroded	1.00	6.1%		VIe	108.8	31.6	24	5	47	
65F	Lindley loam, 18 to 25 percent slopes	0.89	5.4%		VIIe	115.2	33.4	17	10	50	
Weighted Average						3.40	21	6.1	55.4	*-	*n 69.7

**IA has updated the CSR values for each county to CSR2.

*- CSR weighted average cannot be calculated on the current soils data, use prior data version for csr values.

*i Yield data provided by the ISPAID Database version 8.1.1 developed by IA State University.

*n: The aggregation method is "Weighted Average using all components"

*c: Using Capabilities Class Dominant Condition Aggregation Method

Soils data provided by USDA and NRCS.