

Soils Map

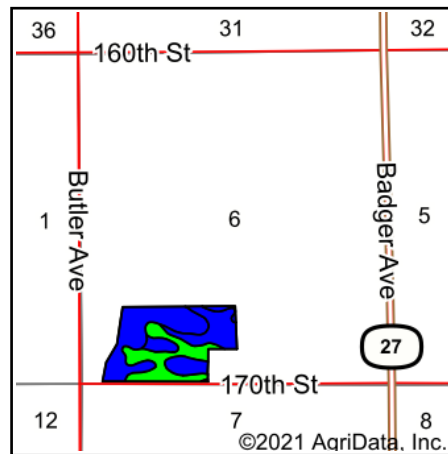

State: **Iowa**
 County: **Bremer**
 Location: **6-92N-14W**
 Township: **Lafayette**
 Acres: **55.76**
 Date: **12/22/2021**

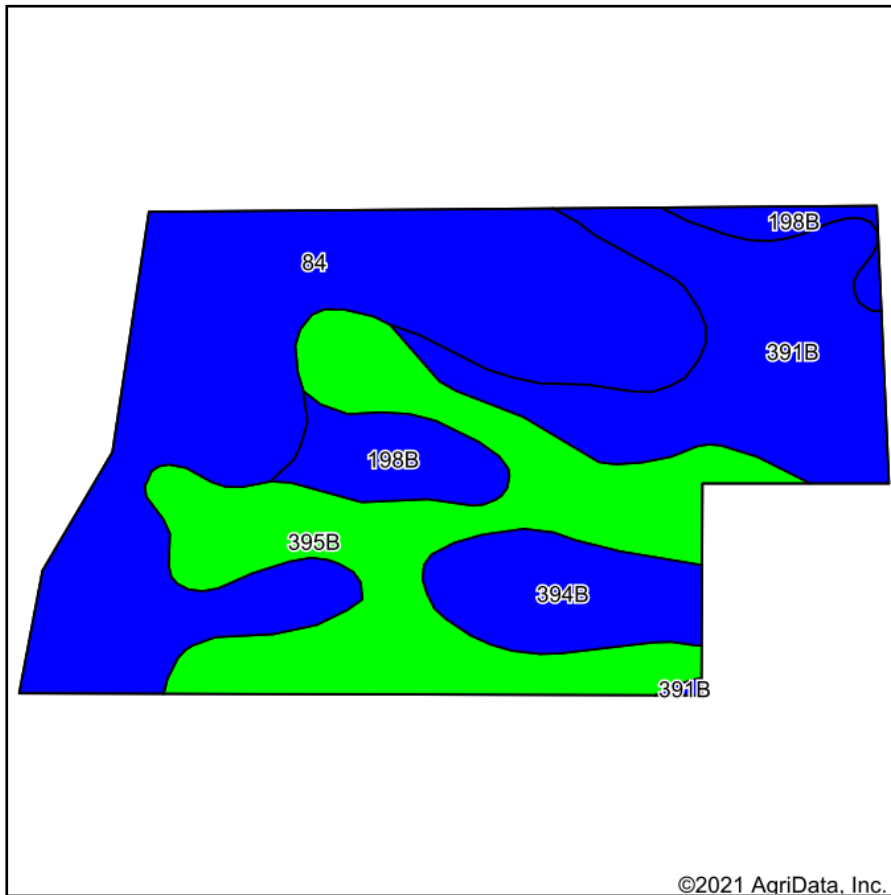

Maps Provided By:

 CUSTOMIZED ONLINE MAPPING
 © AgriData, Inc. 2021 www.AgriDataInc.com



Soils data provided by USDA and NRCS.

Area Symbol: IA017, Soil Area Version: 26

Code	Soil Description	Acres	Percent of field	CSR2 Legend	Non-Irr Class *c	*i Corn Bu	*i Soybeans Bu	CSR2**	CSR	Alfalfa hay Tons	Bromegrass alfalfa AUM	Bromegrass alfalfa hay Tons	Canarygrass hay Tons	Corn Bu	Corn silage Tons	Kentucky bluegrass AUM
84	Clyde silty clay loam, 0 to 3 percent slopes	21.88	39.2%		llw	224	65	88	76	4.4	7	4.2	3	193.5	18	
395B	Marquis loam, 2 to 5 percent slopes	15.52	27.8%		lle	225.6	65.4	91	89							
391B	Clyde-Floyd complex, 1 to 4 percent slopes	10.41	18.7%		llw	216	62.6	87	72							
394B	Ostrander loam, 2 to 5 percent slopes	4.36	7.8%		lle	225.6	65.4	88	85							
198B	Floyd loam, 1 to 4 percent slopes	3.59	6.4%		llw	222.4	64.5	89	80							
Weighted Average						2.00	223	64.7	88.7	79.8	1.7	2.7	1.6	1.2	75.9	7.1

**IA has updated the CSR values for each county to CSR2.

*i Yield data provided by the ISPAID Database version 8.1.1 developed by IA State University.

*n: The aggregation method is "Weighted Average using all components"

*c: Using Capabilities Class Dominant Condition Aggregation Method

Soils data provided by USDA and NRCS.