

Soils Map

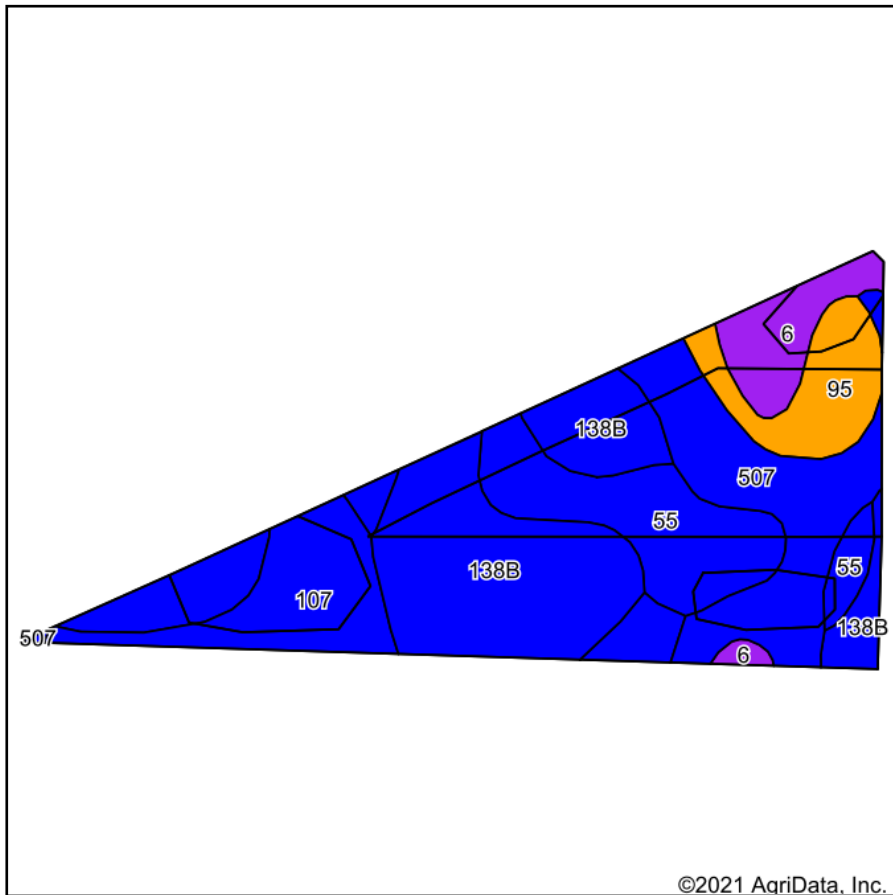

Soils data provided by USDA and NRCS.

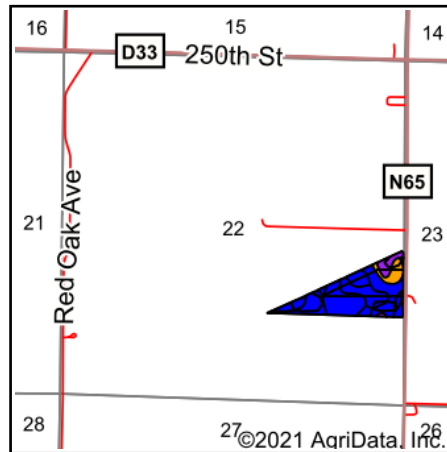

State: **Iowa**
 County: **Calhoun**
 Location: **22-88N-32W**
 Township: **Center**
 Acres: **24.58**
 Date: **5/27/2021**



Maps Provided By:

 CUSTOMIZED ONLINE MAPPING
 © AgriData, Inc. 2021 www.AgriDataInc.com



Area Symbol: IA025, Soil Area Version: 30

Code	Soil Description	Acres	Percent of field	CSR2 Legend	Non-Irr Class *c	CSR2**	CSR	*n NCCPI Overall	*n NCCPI Corn	*n NCCPI Small Grains	*n NCCPI Soybeans
138B	Clarion loam, 2 to 6 percent slopes	7.40	30.1%		Ile	89	80	84	80	63	84
55	Nicollet clay loam, 1 to 3 percent slopes	5.43	22.1%		Iw	89	88	82	81	64	82
507	Canisteo clay loam, 0 to 2 percent slopes	4.56	18.6%		Ilw	84	78	81	71	56	81
107	Webster clay loam, 0 to 2 percent slopes	3.43	14.0%		Ilw	86	83	83	78	60	82
95	Harps clay loam, 0 to 2 percent slopes	2.06	8.4%		Ilw	72	62	82	70	54	82
6	Okoboji silty clay loam, 0 to 1 percent slopes	1.70	6.9%		Illw	59	57	76	74	64	74
Weighted Average						84.2	78.7	*n 82.1	*n 77	*n 60.8	*n 81.9

**IA has updated the CSR values for each county to CSR2.
 *n: The aggregation method is "Weighted Average using all components"
 *c: Using Capabilities Class Dominant Condition Aggregation Method
 Soils data provided by USDA and NRCS.