

# Soils Map

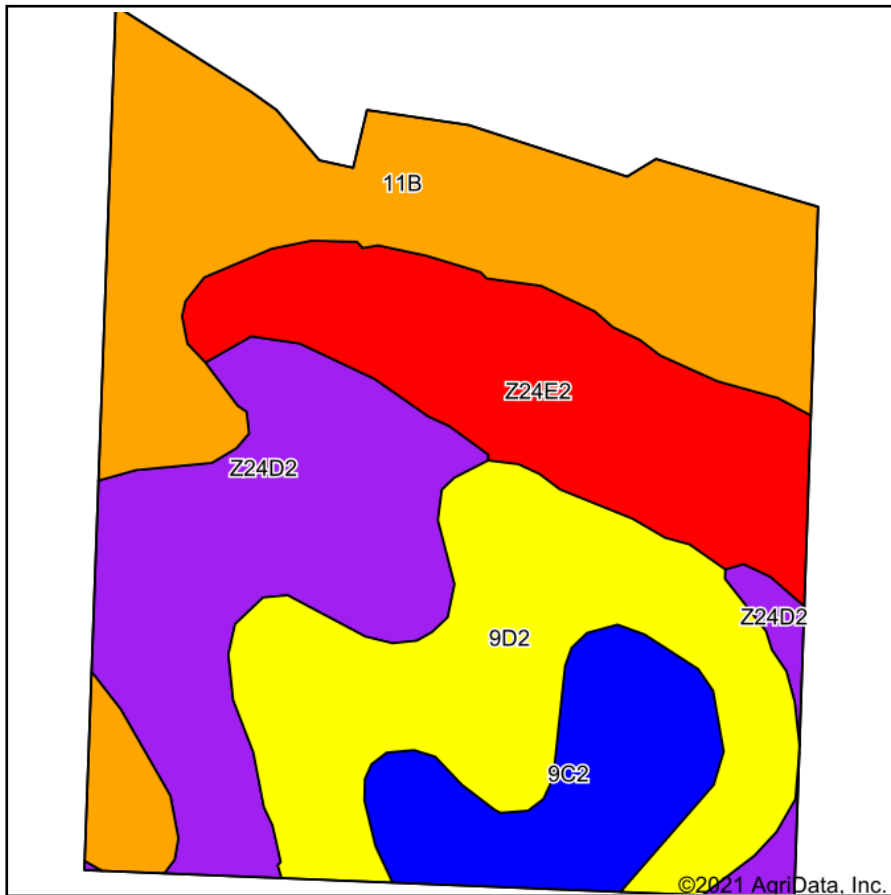

Soils data provided by USDA and NRCS.

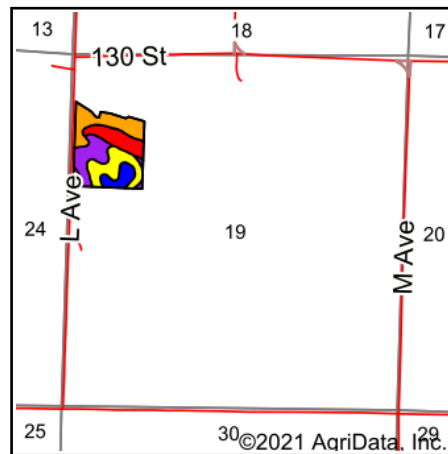

State: **Iowa**  
 County: **Montgomery**  
 Location: **19-73N-37W**  
 Township: **Pilot Grove**  
 Acres: **26.31**  
 Date: **4/22/2021**



Maps Provided By:  
  
 CUSTOMIZED ONLINE MAPPING  
 © AgriData, Inc. 2021 www.AgriDataInc.com



Area Symbol: IA137, Soil Area Version: 28

| Code                    | Soil Description  | Acres | Percent of field | CSR2 Legend | Non-Irr Class *c | *i Corn      | *i Soybeans | CSR2**      | CSR       | *n NCCPI Soybeans |
|-------------------------|---|-------|------------------|-------------|------------------|--------------|-------------|-------------|-----------|-------------------|
| 11B                     | Ackmore-Colo-Judson complex, 2 to 5 percent slopes            | 7.46  | 28.4%            |             | Ilw              | 200          | 58          | 79          | 68        | 82                |
| 9D2                     | Marshall silty clay loam, 9 to 14 percent slopes, eroded      | 5.94  | 22.6%            |             | Ille             | 177.6        | 51.5        | 61          | 58        | 66                |
| Z24D2                   | Shelby clay loam, deep loess, 9 to 14 percent slopes, eroded  | 5.61  | 21.3%            |             | Ille             | 0            | 0           | 52          |           | 56                |
| Z24E2                   | Shelby clay loam, deep loess, 14 to 18 percent slopes, eroded | 4.69  | 17.8%            |             | Ive              | 0            | 0           | 38          |           | 51                |
| 9C2                     | Marshall silty clay loam, 5 to 9 percent slopes, eroded       | 2.61  | 9.9%             |             | Ille             | 211.2        | 61.2        | 87          | 68        | 71                |
| <b>Weighted Average</b> |   |       |                  |             |                  | <b>117.8</b> | <b>34.1</b> | <b>62.7</b> | <b>*-</b> | <b>*n 66.2</b>    |

\*\*IA has updated the CSR values for each county to CSR2.

\*- CSR weighted average cannot be calculated on the current soils data, use prior data version for csr values.

\*i Yield data provided by the ISPAID Database version 8.1.1 developed by IA State University.

\*n: The aggregation method is "Weighted Average using all components"

\*c: Using Capabilities Class Dominant Condition Aggregation Method

Soils data provided by USDA and NRCS.