

T-92-N

AFTON PLAT

(Landowners)

R-39-W

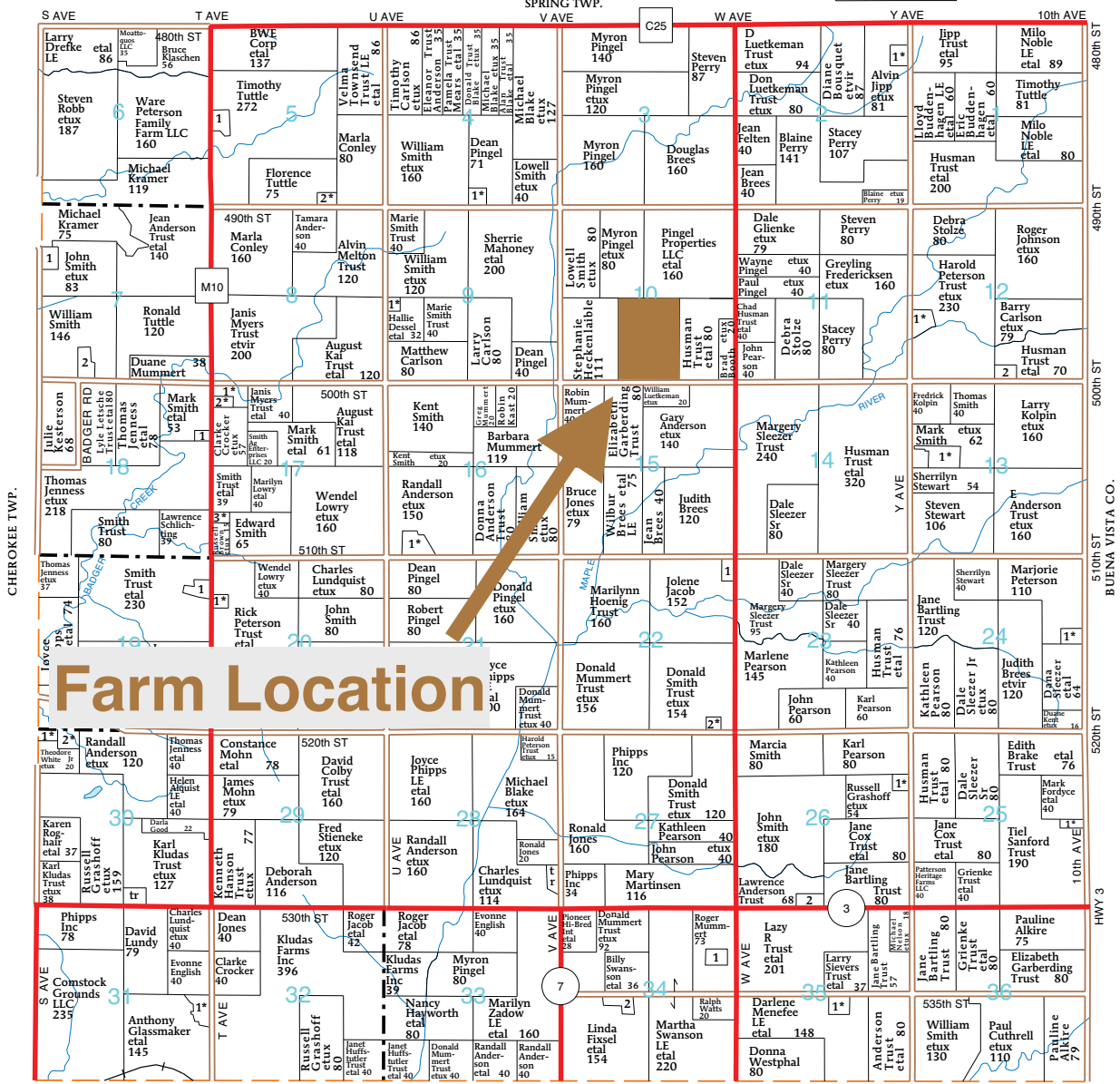
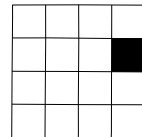

Farm Location

AFTON TOWNSHIP

SECTION 2

- 1. Jipp Trust 6

SECTION 4

- 1. Schlee, Mark et ux 9

SECTION 5

- 1. Pingel Farms 8
- 2. Tuttle, Jeff et ux 5

SECTION 7

- 1. Daum, Arlen 6
- 2. Kohn, John 6

SECTION 9

- 1. Smith, Zachary et ux 8

SECTION 12

- 1. Niemeier, Daniel et ux 8

SECTION 13

- 2. Scharton, Mark 10

SECTION 16

- 1. Smith Agricultural Enterprises LLC 18

SECTION 17

- 1. Jensen, Gary et ux 10

SECTION 18

- 1. Carlson, Matthew et ux 17

SECTION 19

- 2. McGuire, Jessie et ux 5
- 3. Smith, Kent et ux 5

SECTION 20

- 1. Smith, Brian 5

SECTION 21

- 1. Smith Ag Enterprises LLC 10

SECTION 22

- 1. Koch, Scott et ux 8

SECTION 23

- 1. Sleezer Sr, Dale 8

SECTION 24

- 2. Smith, John et ux 6

SECTION 25

- 1. Sangwin, Mark et ux 10

SECTION 26

- 1. Anderson Trust 10

SECTION 27

- 1. Grashoff, Dolan et ux 6
- 2. County of Cherokee 7

SECTION 28

- 1. Chaffin, Brian et ux 5
- 2. Davis, Randall et ux 9

SECTION 29

- 1. Galvin, Teddy et ux 10

SECTION 30

- 1. Nelson, Gayle 7

SECTION 31

- 2. Swanson, Billy 6

SECTION 32

- 1. Smith, Dana et ux 10

CHICAGO CENTRAL & PACIFIC RR CO

PITCHER TWP.

HWY 3

BUENA VISTA CO.

CHEROKEE TWP.