

Soils Map

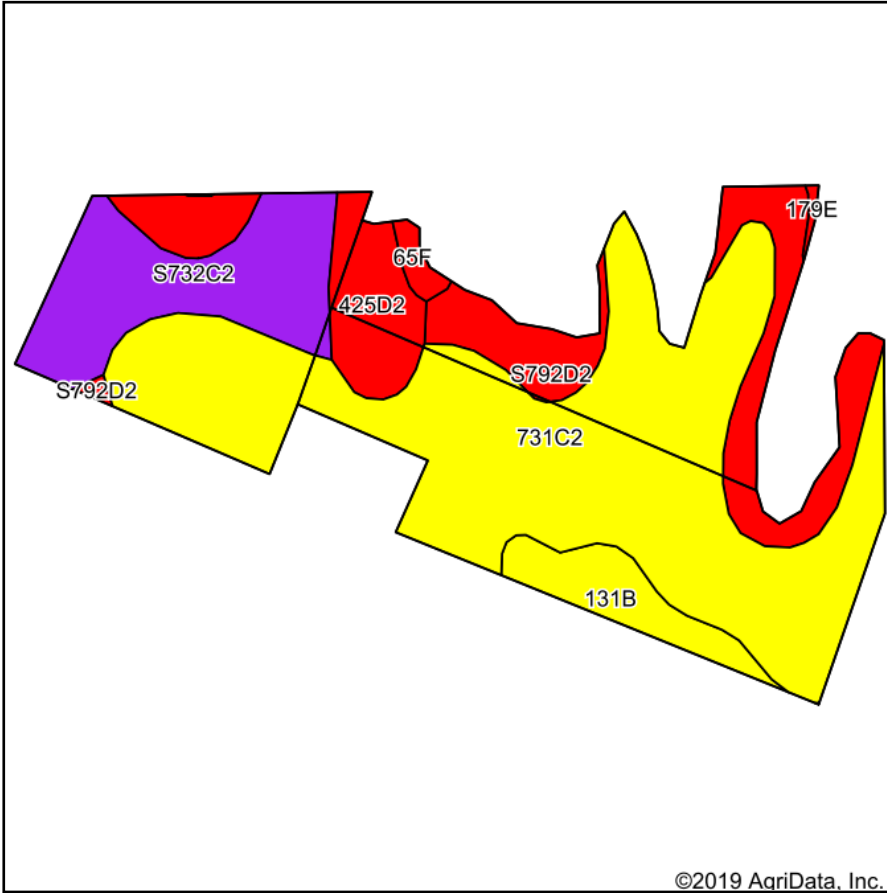

Soils data provided by USDA and NRCS.

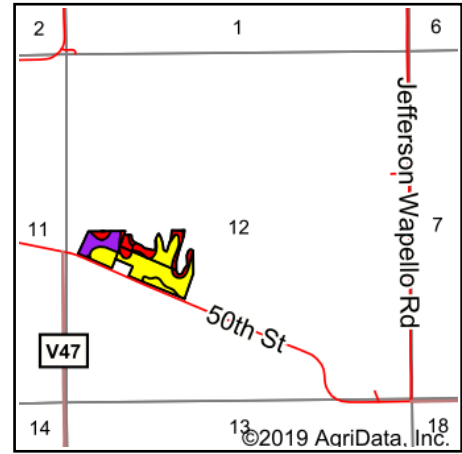

State: **Iowa**
 County: **Wapello**
 Location: **12-71N-12W**
 Township: **Washington**
 Acres: **21.43**
 Date: **5/4/2020**



Maps Provided By:



Area Symbol: IA179. Soil Area Version: 28									
Code	Soil Description	Acres	Percent of field	CSR2 Legend	Non-Irr Class *c	CSR2**	CSR	*n NCCPI Soybeans	
731C2	Pershing silty clay loam, 5 to 9 percent slopes, moderately eroded	11.99	55.9%		IIIe	62	40	55	
S732C2	Weller silty clay loam, 5 to 9 percent slopes, moderately eroded	3.22	15.0%		IIIe	59		67	
S792D2	Armstrong loam, 9 to 14 percent slopes, moderately eroded	2.89	13.5%		IVe	9		42	
425D2	Keswick loam, 9 to 14 percent slopes, moderately eroded	1.96	9.1%		IVe	9	5	33	
131B	Pershing silt loam, 2 to 5 percent slopes	1.17	5.5%		IIIe	70	65	62	
65F	Lindley loam, 18 to 25 percent slopes	0.20	0.9%		VIIe	17	10	49	
Weighted Average						49.6	*-	*n 53.4	

**IA has updated the CSR values for each county to CSR2.

*- CSR weighted average cannot be calculated on the current soils data, use prior data version for csr values.

*n: The aggregation method is "Weighted Average using major components"

*c: Using Capabilities Class Dominant Condition Aggregation Method

Soils data provided by USDA and NRCS.