

# Soils Map

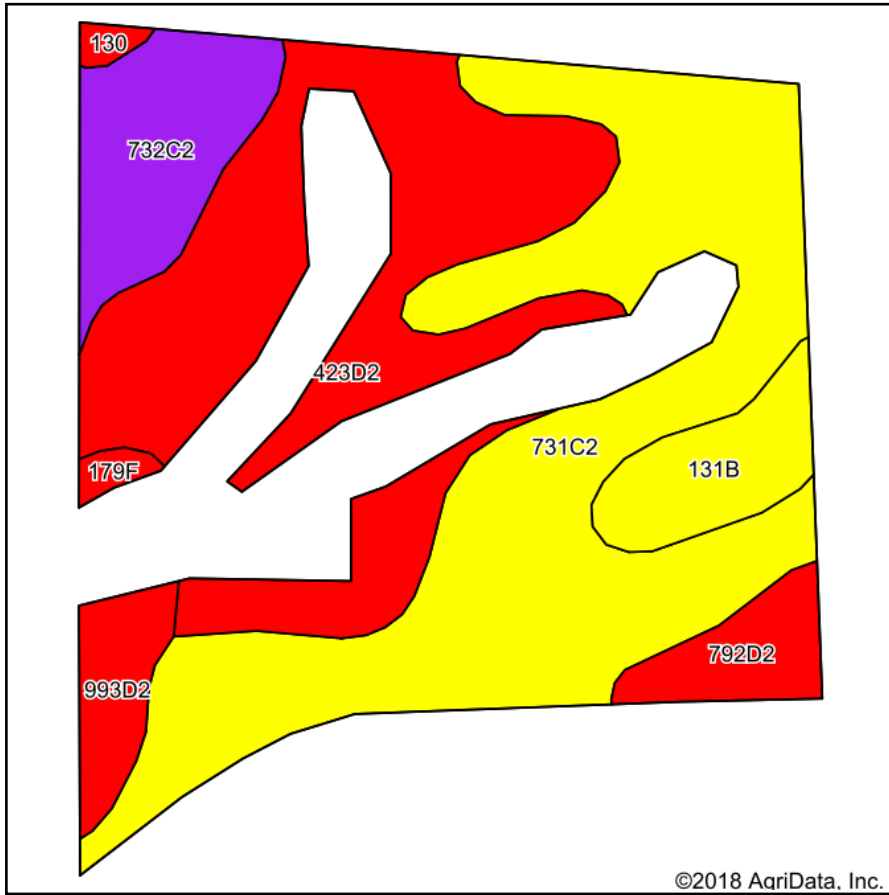

Soils data provided by USDA and NRCS.

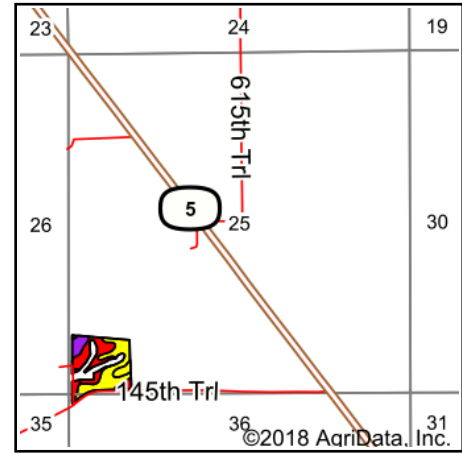

State: **Iowa**  
 County: **Monroe**  
 Location: **25-73N-18W**  
 Township: **Union**  
 Acres: **14.23**  
 Date: **6/20/2018**



Maps Provided By:



**Area Symbol: IA135, Soil Area Version: 25**

Code	Soil Description	Acres	Percent of field	CSR2 Legend	Non-Irr Class *c	CSR2**	CSR
731C2	Pershing silty clay loam, 5 to 9 percent slopes, moderately eroded	6.29	44.2%		IIIe	62	45
423D2	Bucknell silty clay loam, 9 to 14 percent slopes, moderately eroded	4.48	31.5%		IVe	7	13
732C2	Weller silty clay loam, 5 to 9 percent slopes, moderately eroded	1.32	9.3%		IIIe	59	40
131B	Pershing silt loam, 2 to 5 percent slopes	0.83	5.8%		IIIe	70	67
792D2	Armstrong loam, 9 to 14 percent slopes, moderately eroded	0.58	4.1%		IVe	26	13
993D2	Gara-Armstrong loams, 9 to 14 percent slopes, moderately eroded	0.55	3.9%		IVe	35	20
179F	Gara loam, 18 to 25 percent slopes	0.10	0.7%		VIe	19	15
130	Belinda silt loam, 0 to 2 percent slopes	0.08	0.6%		IIIw	47	63
<b>Weighted Average</b>						<b>42</b>	<b>33.4</b>

\*\*IA has updated the CSR values for each county to CSR2.

\*c: Using Capabilities Class Dominant Condition Aggregation Method

Soils data provided by USDA and NRCS.